

REVISIONS				
REV.	DATE	DESCRIPTION	ECO	BY
A	11/11/2009	PRODUCTION RELEASE	100596	SLS

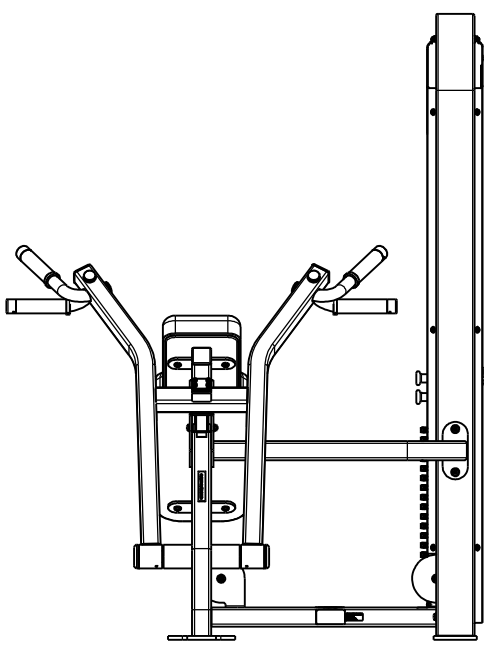
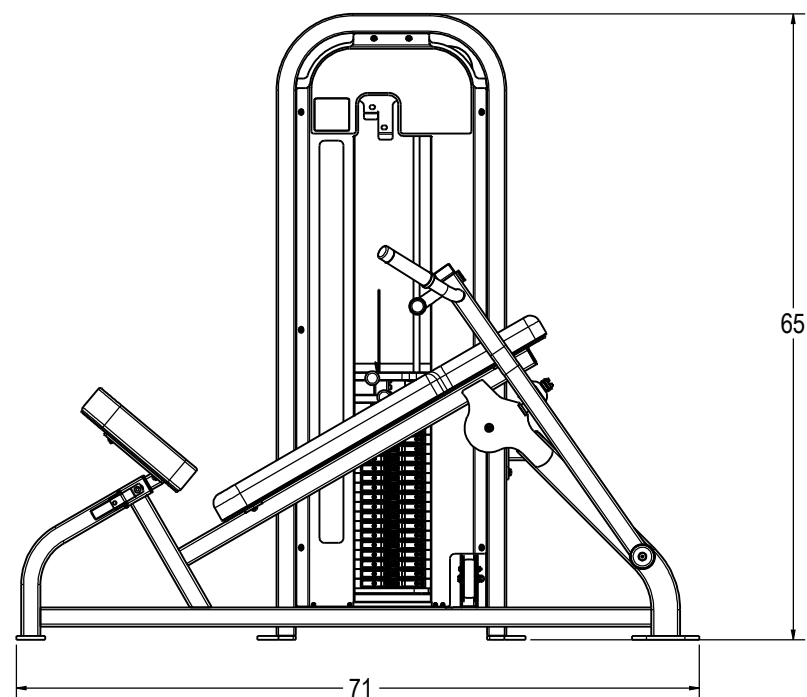
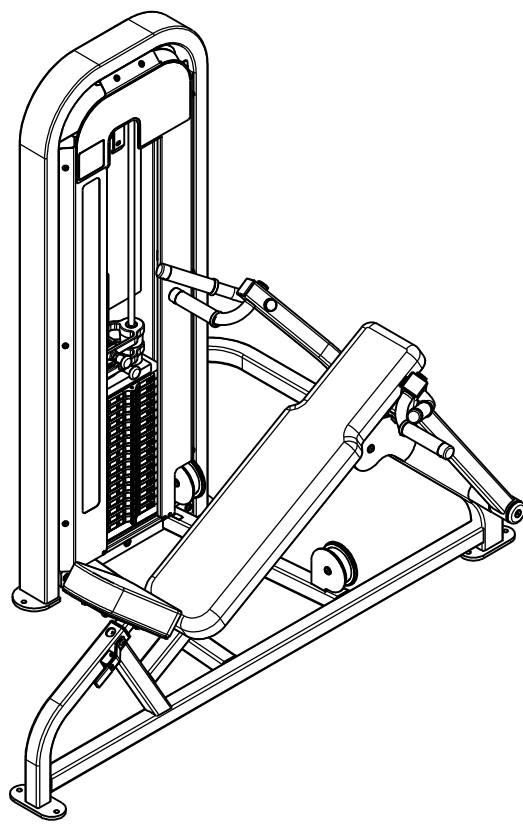
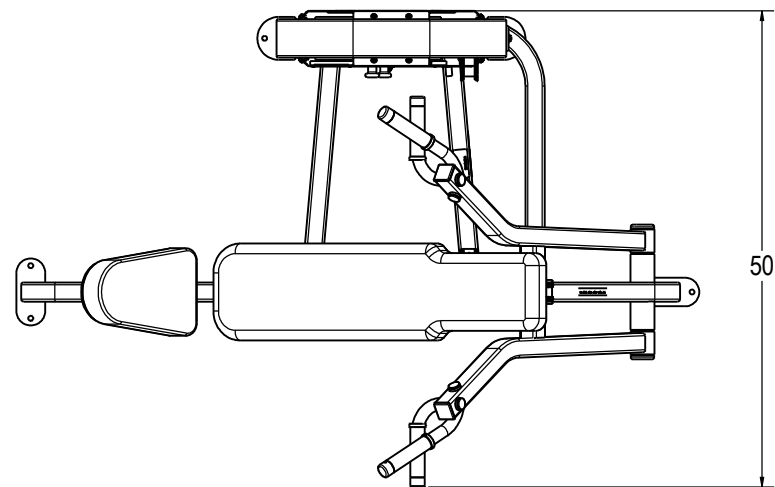

ITEM NO.	PART NUMBER	DESCRIPTION	QTY.
1	3211-0143	ASSY, WELD, MAIN FRAME, PR-S4303	1
2	3211-0145	ASSY, WELD, HANDLES, S4303	1
3	3210-0348	ASSY, WELD, SEAT POST, 20"	1
4	4900-PNTX	POWDER COAT, TBD	2.0 LBS.
5	3311-0394	ASSY, MECH, WT FRAME, S4303E LL	1
6	3500-0025	ASSY, UPHOLSTRY, 13 7/8 X 8 7/8, FC-202-C	1
7	3500-0069	ASSY, UPHOLSTRY, 10x34, FS-403-A	1
8	4900-UPHX	UPHOLSTRY, TBD	1.5 LIN. YDS.
9	1400-0008	TUBE, 1.50 OD, 1.25 ID, RUBBER, BLK	21 IN.
10	2120-0154	PLATE, BELT CLAMP, 1/4, BC-002	2
11	2120-3826	CAP, BEARING 2 1/2 RND ALUM	2
12	2120-3876	CAP, HANDLE, 1 1/4	4
13	2120-3877	RING, HANDLE, 1 1/4	4
14	2120-3884	SHAFT, HANDLE PIVOT, SH, PRESS	1
15	2210-0009	BUSHING, SEAT POST	1
16	3290-0001	ASSY, WELDMENT, HANDLE	1
17	4210-0030	FHSCS, 3/8-16 X .875, BRIGHT, Z	2
18	4220-0005	SHCS, 1/4-20 X 1.0	4
19	4230-0051	BHSCS, 3/8-16 X 2 1/2, BRIGHT, Z	1
20	4230-0056	BHSCS, 3/8 X 3, BRIGHT, Z	1
21	4230-0059	BHSCS, 3/8-16 X 4 1/4, BRIGHT, Z	3
22	4230-0060	BHSCS, 3/8-16 X 2 3/4, BRIGHT, Z	2
23	4230-0069	BHSCS, 1/4-20 X 1 3/4, BRIGHT, Z	1
24	4230-0083	BHSCS, 5/16-18 X 1 1/4, BRIGHT, Z	8
25	4230-0093	BHSCS, 1/4-20 X 3/4, BRIGHT, Z	1
26	4250-0001	SSS, 10-32 X 1/8, BLK	16
27	4250-0015	SSSCP, 1/4-20 X 1/2, BLK	2
28	4500-0008	Nut, JAM, 1/4-20, Z	1
29	4500-0029	NUT, NYLOC, JAM, 3/8-16, Z	7
30	4600-0007	WASHER, SAE, 5/16, Z	8
31	4600-0009	WASHER, SAE, 3/8-16, Z	14
32	4800-0001	BELT, MECTROL	150 IN.
33	4900-0052	SPRING, O D .5, L 1.5, CENTURY 921	1
34	4900-0108	SLEEVE, HANDLE, RED	1
35	4900-0139	BEARING, 1 ID X 2 OD, NR16-Z	2
36	4900-0440	PULLEY, BELT, 4.75D, 3.8B, 1.5W, MOLDED	1
37	4900-0445	PULLEY, BELT, 4.75D, 3.8B, 2.0W, MOLDED	1
38	4900-0588	CAP, 2.0 X 2.0, BLACK, TEXTURED	3
39	4900-0589	CAP, 2.0 X 3.0, BLACK, TEXTURED	1
40	4900-0591	CAP, Ø1.25, BLACK, TEXTURED	4
41	5220-0002	LABEL, SAFETY, KEEP HANDS, SMALL	1
42	5220-0005	LABEL, SAFETY, SECURE TO FLOOR	1
43	5220-0028	LABEL, SAFETY, PINCH POINTS	2
44	5290-0001	SERIAL NUMBER	1
45	050-2190	LABEL, PATENTS, LNL	1
46	730-0913	BUMPER	2

NOTES:
 1. INTERPRET DRAWING PER ASME Y14.5M-1994.
 2. IF APPLICABLE, CRITICAL DIMENSIONS LABELED.
 3. ALL HARDWARE IS KITTED PER 3700-0507.
 4. ALL UPHOLSTERY IS KITTED PER 3700-0094.
 5. EST. GROSS WT. 565 LBS.

DOCUMENT STATUS:
 RELEASED

NOTICE OF PROPRIETARY INFORMATION
 THIS DOCUMENT SHALL NOT BE REPRODUCED NOR SHALL THE INFORMATION CONTAINED HEREIN BE USED BY OR DISCLOSED TO OTHER EXCEPT AS EXPRESSLY AUTHORIZED BY UNISEN

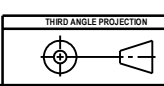

MATERIAL
 SEE BOM

FINISH
 N/A

VENDOR: N/A

UNLESS OTHERWISE SPECIFIED DIMENSIONS ARE IN INCHES. TOLERANCES ARE:
 DECIMALS: .015
 FRACTIONS: 1/32
 ANGLES: ±.01°
 HOLE POSITION: ±.010
 HOLE DIA: ±.005

DATE: 10/23/2009
 DRAWN: SLS
 CHECKED: [blank]
 APPROVED: [blank]

U.O.M.: INCH

UNISEN, INC. DBA 14410 Myford Road
 Irvine CA 92606

STAR TRAC
 9LL-S4303EXXXXXX
 TITLE: SHOULDER PRESS, LL

SCALE: 1:10 SHEET 1 OF 2 SHEET SIZE: D

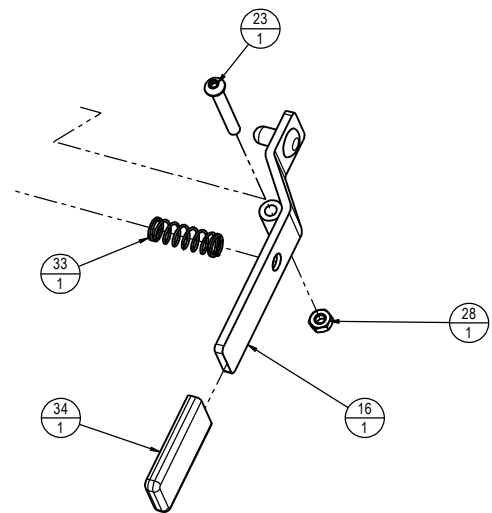

DETAIL A
SCALE 1:2

