

REVISION HISTORY

REV	DATE	DESCRIPTION	ECO	BY
A	11/12/2009	RELEASE FOR PRODUCTION	100596	SLS

ITEM NO.	PART NO.	DESCRIPTION	QTY.	ITEM NO.	PART NO.	DESCRIPTION	QTY.	ITEM NO.	PART NO.	DESCRIPTION	QTY.
1	2140-0201	BAR,BENT, 3/4 R.D, 14, 12	1		2140-0215	HANDLE,RT 1R CR 8 X 9 X 6	1	27	4220-0040	SHCS, 1/2-20 X 3	1
2	3210-0060	ASSY,WELD,ROM,PL-165	1		2140-0216	HANDLE, LT 1R CR 8 X 9 X	1	28	4230-0026	BHSCS, 3/8-16 X 3 3/4	1
	2120-0073	PLATE, MOUNT, CAM, ROM	1		2140-0238	TUBE,BENT,2 X 2 X 120,36,	1	29	4500-0004	NUT,□-20,NYLOC,NE,STL,Z	4
	2120-0495	SHAFT, 1R X 14, 3 3/8 SHL	1		2140-0291	TUBE, BENT, 2 X 2, 2X 90□	1	30	4500-0009	NUT,3/8-16,NYLOC,NTE,STL,	2
	2165-0003	ROM, ADJ.,,500	1		4900-0340	END CAP, 1/8 X 1 7/8, 2 7	2	31	4500-0017	NUT,5/16-18,NYLOC,NTE,AS,	2
3	3210-0362	ASSY,WELD,RIGHT LEG,PL-16	1	6	3311-0378	ASSY, MECH,WGT FRAME,S130	1	32	4500-0018	NUT,3/8-16,NYLOC,NE,STL,Z	4
	2120-0100	MOUNT, STOP, 2 BOLT	1		3700-0216	UPHOLSTERY KIT, PR-S1307	1	33	4500-0029	NUT, NYLOC, JAM, 3/8-16,	3
	2120-0704	TUBE, CUT, 1 1/2 DOM X 8	1	7	3500-0034	ASSY, UPH, 22 X 10, PC-26	1	34	4600-0007	WASHER,5/16,SAE,SS,Z	9
	2120-0705	BAR, CUT, 1/4 X 1 X 2 7/8	1		2300-0010	WOOD, MDF, 22 X 10, PC-26	1	35	4600-0008	WASHER,□,SAE,SS,Z	5
	2120-0717	TUBE, CUT, 2 X 3 X 11 3/4	1		2300-0122	WOOD, LUAN, 22 X 10, PC-2	1	36	4600-0009	WASHER,3/8,USS,Z	6
	2120-0726	TUBE, CUT, 1 1/2 X 1 1/2	1		2500-0014	FOAM, 22 1/2 X 10 3/8 X 4	1	37	4600-0013	WASHER,3/8,SAE,SS,Z	6
	2120-3027	BAR,CUT, 1" CR X 7	2	8	3500-0035	ASSY, UPH, 19 1/2 X 12, F	1	38	4800-0001	BELT, MECTROL, SPOOL	150
	2120-3154	BAR, MACH, 1RD X 1.25, 7/	1		2300-0109	WOOD, MDF, 19 1/2 X 12,FL-	1	39	4900-0001	STOP, 2-BOLT, RED, 3/8	1
	2140-0051	TUBE, BENT, 2 X 2, 80DEG	1		2300-0123	WOOD,LUAN,19 1/2 X 12,FL-	1	40	4900-0004	ROD END, 5/8-18	2
	2163-0002	PAD, PLATE, AB, L250-002	1		2500-0019	FOAM, 20 1/4 X 12 1/2 X 2	1	41	4900-0005	CAP, HANDLE, 1.00	2
	2165-0072	TOP PLATE, R.O.M	1	9	3500-0036	ASSY, UPH, 9 X 7, FL-105-	1	42	4900-0037	BEARING, FLANGE, 1.0 B X	1
	4900-0339	END CAP, 1 7/8 X 1 7/8, 1	1		2300-0101	WOOD, MDF, 9 X 7, FL-105-	1	43	4900-0039	BEARING, 1 ID X 1 1/4 OD X	1
4	3210-0363	ASSY,WELD,LEFT LEG, PL-16	1		2300-0124	WOOD, MDF, 9 X 7, FL-105-	1	44	4900-0052	SPRING, OD .5, L 1.5, CEN	1
	2120-0494	SHAFT, 1R X 14, 11 3/4 SH	1		2500-0023	FOAM, 9 1/2 X 7 1/2 X 1 5	1	45	4900-0056	BARREL, CAM BELT	1
	2120-0708	BAR, CUT, 1/2 X 2 X 4 1/4	1	10	4900-UPHX	UPHOLSTERY, TBD	1	46	4900-0057	BARBELL, CAM, BELT	1
	2120-0717	TUBE, CUT, 2 X 3 X 11 3/4	1		3700-0459	HARDWARE KIT, LL-S1308B	1	47	4900-0058	CLAMP, CAM, BELT	1
	2120-3027	BAR,CUT, 1" CR X 7	2	11	2120-0279	CAP, PULL PIN, 7/8-14, .3	1	48	4900-0062	FLANGE, MOUNT, BEARING, 2	2
	2140-0051	TUBE, BENT, 2 X 2, 80DEG	1	12	2120-0415	PULL PIN, 1/2, 3L, ABD-AD	1	49	4900-0064	BEARING, PILLOW BLOCK, 1"	2
	2163-0002	PAD, PLATE, AB, L250-002	1	13	2120-3184	TUBE, MACH, 1 X 5.5 DOM	1	50	4900-0065	CAP, HANDLE, 3/4"	1
	4900-0339	END CAP, 1 7/8 X 1 7/8, 1	1	14	2120-3485	BAR, MACH, □1 X 2, 5/16-1	1	51	4900-0071	CAM, VRC - 3	1
5	3211-0052	ASSY,WELD, MAIN FRAME,PR-	1	15	2120-3620	TUBE,CUT,2 X 2 X .120,13	2	52	4900-0145	CAP, BLACK, RH-20	19
	2120-0046	BAR, MACH, MOUNT,WT. STK.	1	16	2120-3802	SPACER, 1" OD X 5/8" ID X	2	53	4900-0148	WASHER, CAP, 5/16", RHW-2	9
	2120-0100	MOUNT, STOP, 2 BOLT	1	17	2900-0007	TUBE, GRIP, 1", BLK X 5"	2	54	4900-0149	WASHER, CAP, 3/8", RHW-20	6
	2120-0695	TUBE, CUT, 2 X 2 X 20 5/8	1		1400-0001	TUBE,ROUND, .927 I.D X .1	5	55	4900-0297	LINK CHAIN, #40, PL-170	1
	2120-0697	TUBE, CUT, 2 X 3 X 15 1/2	1	18	2900-0011	TUBE, GRIP, 1" BLK X 6"	4	56	4900-0588	CAP,2.0X2.0,BLACK,TEXTURE	2
	2120-0698	TUBE, CUT, 2 X 3 X 15, .1	1		1400-0001	TUBE,ROUND, .927 I.D X .1	6	57	5220-0023	LABEL, SAFETY, MAIN WARNI	1
	2120-0699	TUBE, CUT, 2 X 3 X 26 1/2	1	19	2900-0012	TUBE, GRIP, 1", BLK X 4 1	1	58	5220-0028	LABEL,SAFETY,PINCH POINTS	1
	2120-0700	TUBE, CUT, 2 X 3 X 8 1/4,	1		1400-0001	TUBE,ROUND, .927 I.D X .1	4.5	59	5220-0029	LABEL, SAFETY, SECURE TO	1
	2120-0702	TUBE, CUT, 2 X 3 X 14, 12	1	20	4161-0005	SCREW,5/16-18,.25,HHC,G5,	4	60	5220-0032	LABEL, SAFETY, KEEP HANDS	1
	2120-0703	BAR, CUT, 1" CR X 2	1	21	4161-0009	SCREW,5/16-18,2.75,HHC,G5	5	61	5290-0001	SERIAL NUMBER	1
	2120-0706	BAR, CUT, 1/2 X 2 X 3, 32	2	22	4161-0018	SCREW,3/8-16,2.0,HHC,HE,G	8	62	050-2190	LABEL,PATENTS,LNL	1
	2120-0707	BAR, CUT, 1/2 X 2 X 5 1/4	1	23	4161-0020	SCREW,3/8-16,2.75,HHC,HE,	4	63	4900-PNTX	POWDER COAT, TBD	3
	2120-1798	BAR,CUT, 1/2 X 2 X 3	1	24	4161-0025	SCREW,3/8-16,4.5,HHC,HE,G	3				
	2120-3259	FOOT, 3/8 X 2, 1 HOLE	1	25	4161-0046	SCREW,5/8-18,1.5,HHC,HE,G	2				
	2120-3264	FOOT, 3/8 X 3, 3, 1 HOLE	1	26	4220-0021	SCREW,□-20,3.5,SHC,HE,AS,	4				

**DOCUMENT STATUS:
RELEASED**

NOTICE OF PROPRIETARY INFORMATION

THIS DOCUMENT SHALL NOT BE REPRODUCED NOR SHALL THE INFORMATION CONTAINED HEREIN BE USED BY OR DISCLOSED TO OTHER EXCEPT AS EXPRESSLY AUTHORIZED BY UNISEN INC, D.B.A. STAR TRAC.

THIRD ANGLE PROJECTION

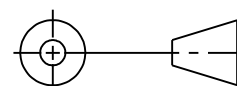

MATERIAL
SEE BOM

FINISH
N/A

VENDOR: **N/A**

P/N: **N/A**

UNLESS OTHERWISE SPECIFIED DIMENSIONS ARE IN INCHES. TOLERANCES ARE:

DECIMALS
X. = ±.13
X.X = ±.05
X.XX = ±.03
X.XXX = ±.010

ANGLES
±2°

DRAWN: SLS DATE: 10/27/2009

CHECKED:
APPROVED:

U.O.M. INCH

UNISEN, INC. DBA
STAR TRAC
14410 Myford Road
Irvine CA 92606

STARTRAC PART NO: **9LL-S1308DXXXXX** REV: **A**

TITLE: **ADDUCTOR, LL**

SCALE: 1:16 SHEET 1 OF 1 SHEET SIZE: B

NOTES:

1. INTERPRET DRAWING PER ASME Y14.5M-1994.
2. REMOVE ALL BURRS AND SHARP EDGES .015/.030.
3. IF APPLICABLE, CRITICAL DIMENSIONS LABELED.
4. ALL HARDWARE KITTED PER 3700-0459.
5. ALL UPHOLSTERY KITTED PER 3700-0216.
6. EST. GROSS WT. 440 LBS.