

SPEED SENSOR REPLACEMENT INSTRUCTIONS

STEP 1. DISCONNECT THE SENSOR FROM THE POWER BOARD PCB.

STEP 2. REMOVE THE ORIGINAL SENSOR, CLAMP, AND HARDWARE SECURING THE SENSOR TO THE ALTERNATOR.

STEP 3. DISCARD THE PARTS REMOVED IN STEP 2.

STEP 4. PLACE NEW SPEED SENSOR ON THE ALTERNATOR , ADJUST THE DISTANCE FROM THE EDGE OF THE DISK FAN TO THE END OF THE SENSOR, AND SECURE WITH NEW HARDWARE INCLUDED IN THE KIT AS SHOWN IN DIAGRAM 1.

NOTE: PLACE A SMALL DROP OF LOCTITE ON THE SCREW THREADS BEFORE TIGHTNING.

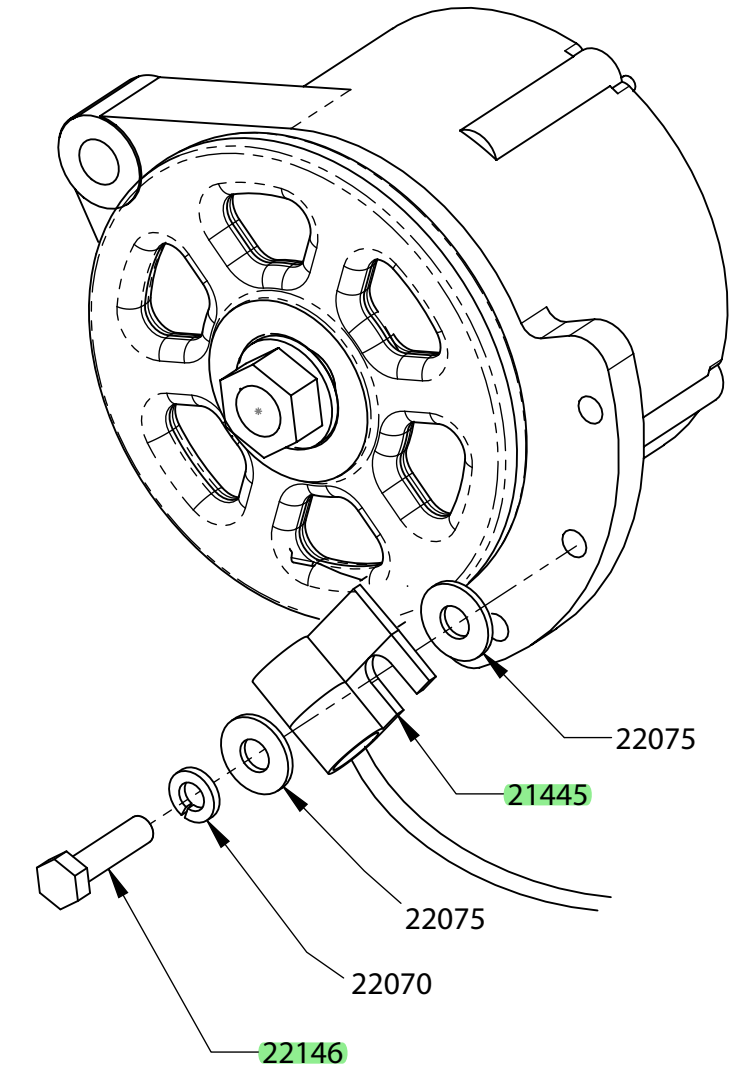
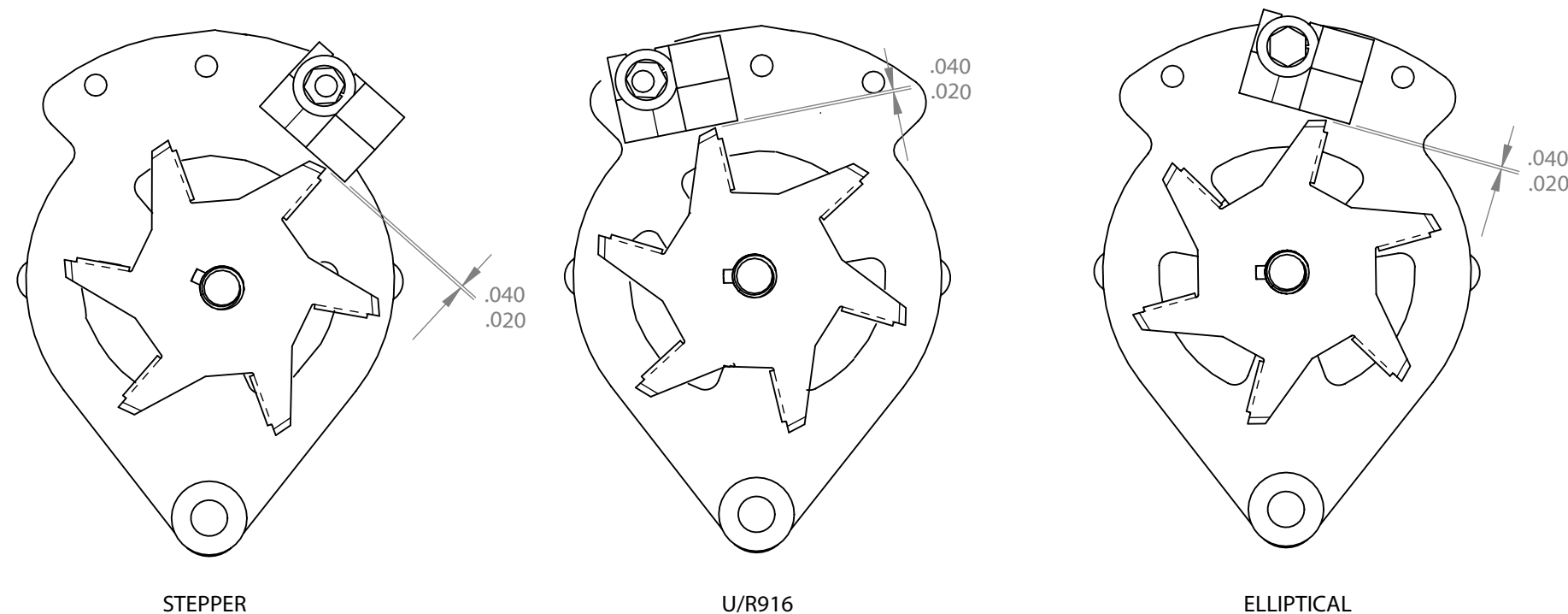

DIAGRAM 1
(ELLIPTICAL ALTERNATOR SHOWN AS EXAMPLE)

IMPORTANT: 1. A FLAT WASHER MUST BE BETWEEN THE SENSOR AND ALTERNATOR, SO THE FAN BLADE MAY BE ALIGNED PROPERLY UNDER THE SENSOR.

2. BOTTOM OF SENSOR TO EDGE OF FAN BLADE DISTANCE (CREDIT CARD THICKNESS).

3. TORQUE BOLT TO 70 in/lbs (8 Nm) WHEN SECURING THE SENSOR, OTHERWISE SENSOR WILL CRACK.