

NOTES:

1. STORAGE & SPARE PART PACKING:
 - a. PACKAGE IN MANNER THAT PARTS WILL NOT BECOME DAMAGED WHILE IN TRANSPORT OR STORAGE.
 - b. AFFIX IDENTIFYING LABEL TO PACKAGING.
2. IDENTIFYING LABEL TO INCLUDE:
 - a. PO NUMBER AND DATE
 - b. ASSEMBLY NUMBER
 - c. BAR CODE OF ASSEMBLY NUMBER (CODE 128)
 - d. ASSEMBLY DESCRIPTION
 - e. ASSEMBLY REVISION
 - f. WEIGHT (LB./ KG.)

REVISION HISTORY				
REV	DATE	DESCRIPTION	ECO	BY
A	4/10/2019	INITIAL RELEASE	16093	JO

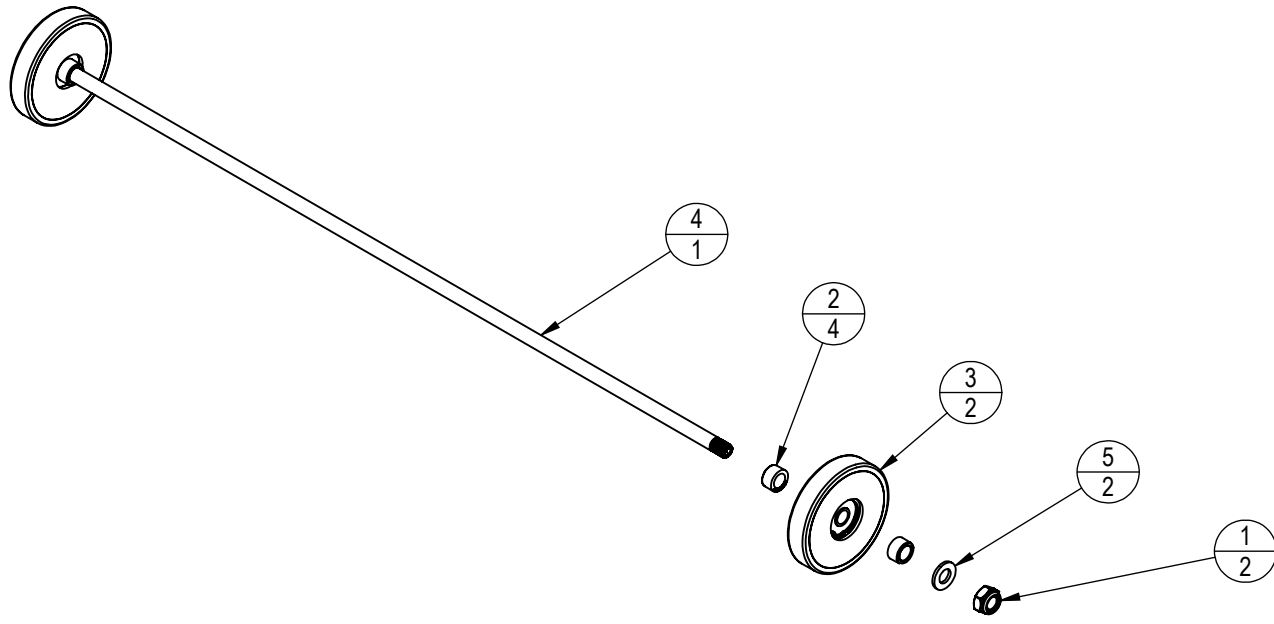

ITEM NO.	PART NUMBER	DESCRIPTION	QTY.
1	110-3973	NUT,M10X1.5,AS,ZC,NYLON	2
2	120-3447	SPACER, OUTER, O.D. 16, I.D. 10.5	4
3	130-1898	WHEEL ASSEM., O.D. 60 x I.D. 10	2
4	711-3595	AXLE SHAFT, STEP PIVOT, M10x1.5	1
5	731-0367	WASHER,PLAIN,M10	2

DOCUMENT STATUS:

NOTICE OF PROPRIETARY INFORMATION
THIS DOCUMENT SHALL NOT BE REPRODUCED NOR SHALL THE INFORMATION CONTAINED HEREIN BE USED BY OR DISCLOSED TO OTHER EXCEPT AS EXPRESSLY AUTHORIZED BY CORE HEALTH & FITNESS, LLC.

CLASS OF WORK	UNLESS OTHERWISE SPECIFIED DIMS ARE IN mm. TOLERANCES FOR MEASURE OF LENGTH ARE:							ANGLES = ±2°
	0.5 to 3	> 3 to 6	> 6 to 30	> 30 to 120	> 120 to 400	> 400 to 1000	> 1000 to 2000	
FINE	±0.05	±0.05	±0.1	±0.15	±0.2	±0.3	±0.5	----
MEDIUM	±0.1	±0.1	±0.2	±0.3	±0.5	±0.8	±1.2	±2
COARSE	±0.2	±0.3	±0.5	±0.8	±1.2	±2	±3	±4
VERY COARSE	----	±0.5	±1	±1.5	±2.5	±4	±6	±8

MATERIAL
SEE BOM

FINISH
N/A

VENDOR: _____ P/N: _____

THIRD ANGLE PROJECTION

DRAWN	INITIAL	DATE
CHECKED	JO	10/05/2018
APPROVED		

CORE HEALTH & FITNESS, LLC
4400 NE 77th Ave., Suite 300
Vancouver, WA 98662

CORE PART NO: **711-3594** REV: **A**

TITLE: **KIT, STEP AXLE, WHEELS, HARDWARE**

SCALE: 1:5 | SHEET 1 OF 1 | SHEET SIZE: B