

NAUTILUS
XPLOAD

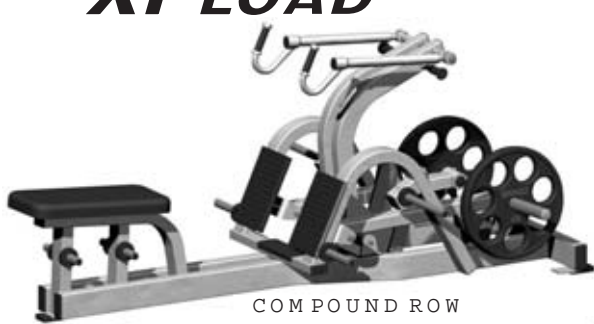

COMPOUND ROW



SEATED CALF



OVERHEAD PRESS



LAT PULLDOWN



INCLINE PRESS



VERTICAL CHEST



LEG PRESS



BICEP CURL



LEG CURL PRONE



INCLINE LEG PRESS



TRICEP EXTENSION



SEATED DIP



DEAD LIFT / SHRUG



LEG EXTENSION

NAUTILUS

XPLOAD

PARTS DIAGRAM

INCLINE PRESS

19-5224

REVISED :
October 6, 2006

PARTS AND SERVICE u 709 Pow erhouse Road u Independence ,
VA 24348
800-235-2233 • Fax: 276-773-2298

SERIAL # _____
through _____



P3IP INCLINE PRESS

- | COMP # | COMPONENT DESCRIPTION |
|--------|---------------------------------------------------|
| 1 | BSF330 PLATED LOADED INCLINE PRESS BASE FRAME |
| 2 | MA3509 R H MOVEMENT ARM ASSY |
| 3 | MA349 LH MOVEMENT ARM ASSY |
| 4 | WA328 RH WEIGHT ARM ASSY |
| 5 | WA327 LH WEIGHT ARM ASSY |
| 6 | HB325 SEAT BACK RATCHET ASSY |
| 7 | LK340 WEIGHT ARM DRIVE LINK |
| 8 | 02-9220 BOLT HH5 3/8 X 1 1/4 |
| 9 | 01-1553 BOLT HH5 3/8 X 4 1/2 |
| 10 | 01-1321 BOLT 1/2 X 2 1/2 HH5 |
| 11 | 01-0011 BOLT HH5 1/2 X 3 |
| 12 | 01-1564 BOLT HH5 1/2 X 4 1/2 |
| 13 | 01-1567 BOLT HH5 1/2 X 6 |
| 14 | 01-2190 BOLT HH5 5/8 X 3 |
| 15 | 01-1566 BOLT HH5 1/2 X 5 1/2 |
| 16 | 01-2286 BOLT HH5 5/8 X 6 3/8 CUT-OFF FROM 01-2287 |
| 17 | 01-2283 BOLT HH5 5/8 X 8 5/8 CUT-OFF |
| 18 | 02-4065 BOLT 1/4-20 X 2 3/4 SLOTTED SCREW |
| 19 | 02-3055 1/4-28 X 1/4 SET SCREW |
| 20 | 03-2030 NUT NTE 3/8 |
| 21 | 03-1055 NUT NTE 1/2 |
| 22 | 03-2060 NUT NTE 5/8 |
| 23 | 03-5101 NUT NTE 1/4 |
| 24 | 03-5118 5/8-18 LEFT HAND THREAD JAM NUT |
| 25 | 03-5119 5/8-18 RIGHT HAND THREAD JAM NUT |
| 26 | 04-2030 WASHER FLAT 1/2 SAE |
| 27 | 04-5213 3/8 NT LOK WASHER |
| 27A | 04-5214 1/2 NT LOK WASHER |
| 27B | 04-5215 5/8 NT LOK WASHER |
| 28 | 04-5225 WASHER NT LOCK BLACK 1/4 |
| 29 | 05-1190 3/4 D X 1 X .760 BRASS BUSHING |
| 30 | 06-8180 RING SNAP 1/2 D, 5100-50 EXTERNAL THIN |
| 31 | 06-8275 RING SNAP EXT. 17mm |
| 32 | 06-9035 ROD ENDS 5/8-18 RH THREADS CTMD-10 |
| 33 | 06-9037 ROD ENDS 5/8-18 LH THREADS CTMDL-10 |
| 34 | 07-5032 MOLDED SEAT TRACK |
| 35 | 07-5033 MOLDED SEAT TRACK 2 |
| 36 | 07-5034 MOLDED WHEELS |
| 37 | 07-5064 203 BEARING |
| 38 | 07-8230 CLEVIS PN 1/2 D X 4 1/2 L |
| 39 | 07-9376 SEAT BEARING SLEEVE |
| 40 | 07-9605 BEARING SLEEVE 1 OD X 5 15/16 L |
| 41 | 09-1003 5/8 x 3" CLOSED END GRP (YELLOW) |

- | COMP # | COMPONENT DESCRIPTION |
|----------------------------------------------|-------------------------------------------------------------|
| 42 | 07-9607 BEARING CUP SW / MOLDED BEARING |
| 43 | 07-9610 BEARING SPACERS |
| 44 | 07-9618 HEM JOINT SPACERS |
| 45 | 07-9625 WEIGHT TUBE 1 7/8 X .25W TUBE X 16" LONG |
| 45A | 07-9661 SHEET BACK SHEET METAL |
| 46 | 07-9662 SLEEVE 3/4 OD X 1/2 D X 5" L |
| 47 | 07-9681 20 DEG ANGLED DOWN SEAT |
| 48 | 09-9550 GRP RING 1.530 D ALUM NUM (FOR 1 1/2" D BAR) |
| 49 | 09-9555 GRP RING 1.780 D ALUM NUM (FOR 1 3/4" D BAR) |
| 50 | 09-1110 HAND GRP 1.438 D X 7 OPEN END |
| 51 | 09-1116 HAND GRP 1.6875 D OPEN END |
| 52 | 09-3055 2 x 4 x 11 GA FRAME PLUG |
| 53 | 09-3064 HOLE PLUG 1/2 D A WHITE |
| 54 | 09-3072 HOLE PLUG 3/8 D A BLACK |
| 55 | 09-3091 HOLE PLUG (YELLOW) |
| 56 | 09-4064 WEIGHT STORAGE, 1.875 D X 3/4 X 3" OD RUBBER |
| 57 | 09-5010 DOCK BUMPER |
| 58 | 09-5045 FOOTPAD RECT (NEW) |
| 59 | 09-9520 GRP CAP 1.530 D ALUM NUM (FOR 1 1/2" D BAR) |
| 60 | 09-9525 GRP CAP 1.780 D ALUM NUM (FOR 1 3/4" D BAR) |
| 61 | 10-1032 EXTENSION SPRING |
| 62 | 12-1001 SEAT INDICATOR ARROW BLACK |
| 63 | 12-1026 KEEP HANDS AWAY (YELLOW) |
| 64 | 12-1080 INSPECTION STICKER DECAL |
| 65 | 12-1104 5/8" W DE DECAL, 1/2" INCREMENTS (1 TOP-11 BOTTOM) |
| 66 | 12-1166 DECAL SEAT ADJUSTMENT INSTRUCTIONS |
| 66A | 12-1167 DECAL SEAT BACK ADJUSTMENT |
| 66B | 12-5326 INSTRUCTIONAL PLACARD P3IP |
| 67 | 19-1014 2 3/4 W DE DBL. SDED TAPE |
| 68 | 19-1291 DECAL SERIAL # BAR CODE |
| 69 | 04-5208 5/8 SAE FLAT WASHER |
| 70 | 19-5224 PARTS DIAGRAM P3IP |
| 71 | 40-7167 BAG 50 X 46 X 86 X .002 THICK |
| 72 | 91-999 PAINT POWDER |
| 73 | JP720 SLPCOVER |
| 74 | JP8010 STD. SEAT BOTTOM PAD |
| 75 | JP8209 STD. SEAT BACK PAD |
| P3IP WEIGHT STORAGE PARTS KIT OPT-W T-BAR 02 | |
| 76 | 07-7010 1/4 X 1 ROLL PINS |
| 77 | 07-9613 WEIGHT STORAGE PN 1 1/4 D A CR X 25 5/8 L |
| 78 | 07-9671 WEIGHT STORAGE PN 1 1/4 D A CR X 22 L |
| 79 | 09-4000 NUMBER PLUG 5 lb. |
| 80 | 09-4001 NUMBER PLUG 10 lb. |
| 81 | 09-4002 NUMBER PLUG 25 lb. |
| 82 | 09-4003 NUMBER PLUG 45 lb. |
| 83 | 09-4066 WEIGHT STORAGE 1.25 D X 3/4 X 3" OD MOLDED BUMPER |
| 84 | 09-9620 TUBE INSERT |
| 85 | 02-2290 1/4 X 1 AFH SCREW |

09-3064 1/2" DIA HOLE PLUGS
 09-3066 1 1/4" DIA HOLE PLUGS
 (USED WITHOUT WEIGHT
 STORAGE PIN KIT.)



RED: PAINTED ITEMS
 _____ Trolleys / Machine

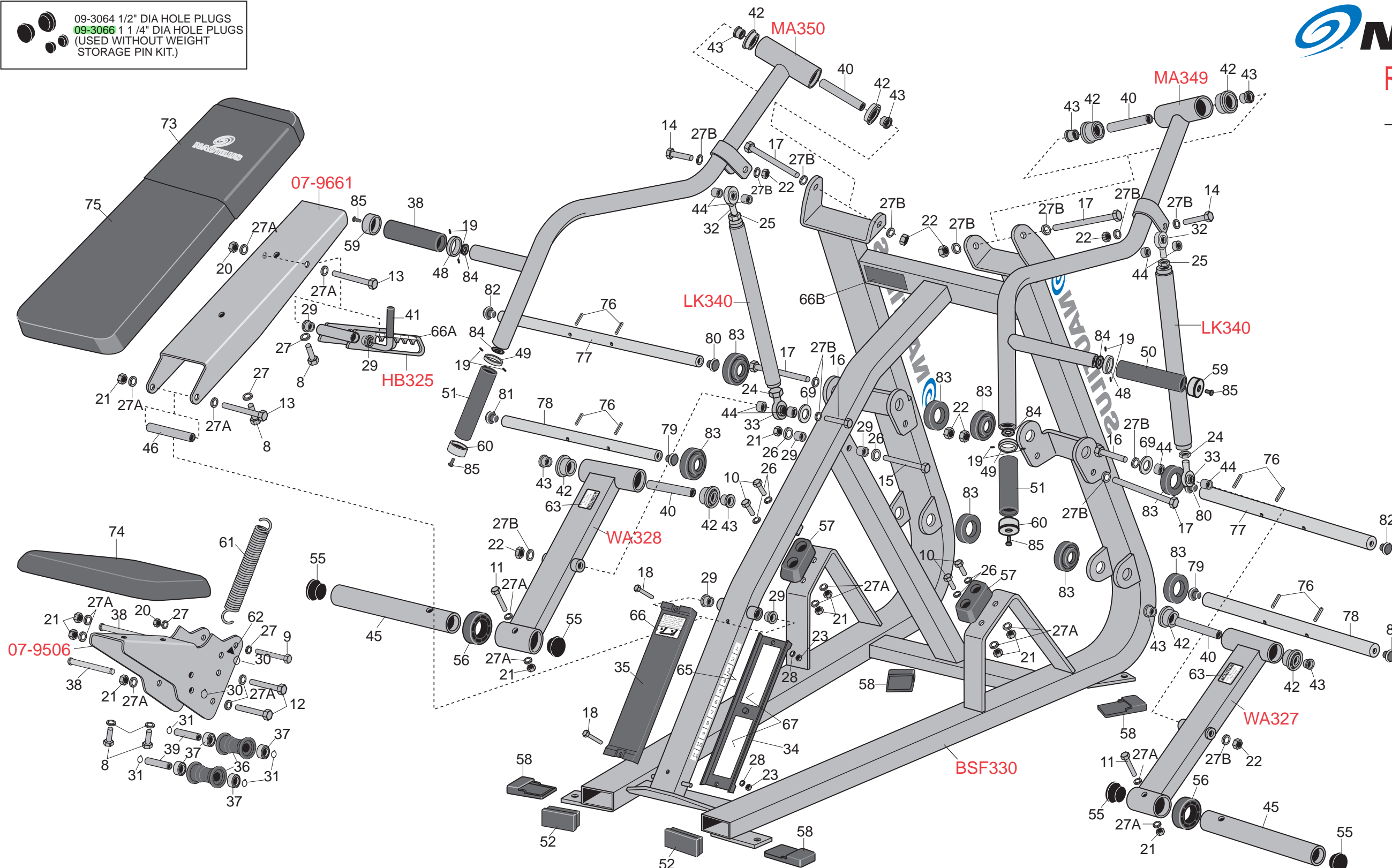

P3IP

INCLINE PRESS
 Nautilus Parts Diagram

LastRevDate:10/06/06



Warranty Information

Nautilus® XP Load™ Variable Resistance Warranty
Limited Warranty Terms & General Specifications

Nautilus warrants only to the original purchaser that Nautilus® commercial exercise equipment from the manufacturer is free from defects in material and workmanship under normal use and service. Our obligation under this warranty shall be limited to the repair or exchange at our plant (a) of any part or parts of the structural frame, moving weldments or weight stacks which may thus prove defective under normal use and service for 12 years from delivery to the original purchaser; (b) of any moving part or parts not otherwise disclosed within this warranty which thus may prove defective under normal use and service within one (1) year from delivery to the original purchaser; and (c) of any upholstery, pads, grips or tethered weight pin connectors which thus may prove defective under normal use and service within 6 months from delivery to the original purchaser. This warranty only applies to those parts that our own examination discloses to our satisfaction to be thus defective. Nautilus will replace, free of charge, safety /caution decals which are missing or damaged.

Nautilus Equipment Warranty

2ST, Nitro Plus, Nitro, XP Load, and Free Weights

12 Years	To original owner for frames, welded moving parts and weight stacks.
3 Years	To original owner under normal use and service for any moving part or parts not otherwise disclosed in this warranty.
1 Year	Labor warranty - To original owner.
6 months	Upholstery, pads, grips and tethered weight stack pins.

Equipment schematics available online at www.nautilus.com for faster repair diagnosis and parts delivery.

This warranty is expressly in lieu of all other warranties, express or implied, including the warranties of merchantability and fitness for use and of all other obligations or liabilities on our part, and we neither assume nor authorize any other person to assume for us any other liability in connection with the sale of this NAUTILUS® commercial exercise equipment. This warranty shall not apply to this NAUTILUS® commercial exercise equipment or to any part thereof which has been subject to accident, negligence, alteration, abuse, misuse, or a lack of maintenance in accordance with our recommended maintenance instructions. We make no warranty whatsoever in respect to accessories or parts not manufactured by us and disclaim all warranties, express or implied, as to such accessories and parts. The term "original purchaser", as used in this warranty, shall be deemed to mean that person or entity for whom this NAUTILUS® commercial exercise equipment is originally installed. This warranty shall apply only within the boundaries of the continental United States.

NAUTILUS® shall not be liable for any loss or damage, including incidental or consequential damages resulting directly or indirectly from the use or loss of use of our NAUTILUS® commercial exercise equipment. Without limiting the generality of the foregoing, this exclusion from liability embraces the purchaser's expenses for downtime or for making up downtime, damages for which the purchaser may be liable to other persons, damages to property, and injury to or death of any persons. We neither assume nor authorize any person to assume for us any liability in connection with sale or use of our equipment. There are no oral agreements or warranties collateral to or affecting this agreement.

Dealer Acknowledgment Notice:

Nautilus Commercial Warranty times begin 30 days after product has been shipped from our manufacturing plant to your warehouse or storage site, unless otherwise specified at time of customer pickup.

WARNING

Store indoors only. Do not subject machine to high humidity or damp conditions.



Maintenance
INSTRUCTIONS

For XP Load Strength Training
Equipment



Getting maximum results from Nautilus®
machines depends on proper
maintenance of equipment.

Welcome

Congratulations on choosing Nautilus® XP Load™ strength training equipment. The addition of several exciting new features to the Nautilus® line, as outlined in these instructions, ensures that your equipment will operate with little scheduled maintenance. We know this is important to you and your customers, so please take a few minutes to read the following instructions for keeping your Nautilus® equipment in the best working condition.

Contents

Welcome1

Parts & Service1

Safety/Before Exercising2

Maintenance Schedule2

General Maintenance3

Mini-Weight Stack Pin Replacement.....3

Cleaning3

Lubrication3

Warranty Information4

Parts & Services

Regular and scheduled maintenance will prolong the life of your Nautilus equipment. Should you have to replace parts, use only genuine Nautilus parts. The Nautilus Customer Service Team invites you to call in your order for replacement parts. They're never too busy to discuss or offer a tip on your maintenance tasks.

Nautilus machines — the culmination of years of research and refinement — are made from the highest quality materials, under exacting conditions. The quality control tag attached to each machine before shipping ensures that each unit has been thoroughly inspected to meet Nautilus' strict requirements.

Should you, the owner of a Nautilus machine, need to replace any parts because of normal wear and tear, or should your machine ever need maintenance, Nautilus invites you to call our Virginia Headquarters office for information on parts and service.

Nautilus has available: detailed isometric drawings on the website @ www.nautilus.com for each machine manufactured, genuine Nautilus Upholstery Pads, Naugahyde® Spray Cleaner/Conditioner recommended for Nautilus upholstery pads and TFL #50 Wet Lubricant recommended for the care of the guide rods of Nautilus selectorized resistance machines.

Nautilus' concern for the customer does not end with the purchase of equipment. Your comments are always welcomed. In the unlikely event that a problem occurs, call us toll free:



Nautilus
Customer Service
800-NAUTILUS
Fax: 276-773-2298

Safety

- 1. Supervision is necessary when the machine is used by or near children, invalids, or disabled persons.
- 2. Follow the instructions for specific exercises on each machine
- 3. Get in and out of the equipment carefully.
- 4. Never operate the machine without shields in place.
- 5. Use only Nautilus selector pins in weight stack. Never drop or insert any other object into machine opening.
- 6. Use this machine only as intended or described in this manual.
- 7. Do not operate equipment with loose or damaged parts. If machine fails to operate correctly, do not attempt to repair. Notify authorized personnel of the problem.
- 8. Keep hands and feet clear of weights and other moving parts when in use. Keep hands and feet only on the hand grips and footpads provided.
- 9. Failure to comply with these instructions may result in personal injury.

Nautilus will replace, free of charge, safety /caution decals which are missing or damaged.

CAUTION

Stop exercising immediately if you experience a sharp nerve or joint pain, and seek medical advice.

Maintenance Schedule

	DAILY	WEEKLY	MONTHLY	EVERY 6 MONTHS
General Maintenance				
Check Safety & Warning Decals	n			
Inspect Belts & Cables	n			
Spot Check Belt			n	
Spot Check Nuts and Bolts			n	
Spot Check All Pegs and Stops			n	
Examine Rotation Points				n
Cleaning				
Clean Upholstery	n			
Use Quick Fill A-33 Disinfectant Cleaner.				
Clean Surface Area		n		
Remove Dust				n
Lubrication				
Lubricate and Clean Guide Rods Using TFL 50		n		
Do not lubricate hydraulic cylinders.				

Before Exercising

To guard against injury, all equipment users should follow these instructions.

- n Check with your physician and get approval before beginning a training routine.
- n Become familiar with the equipment before beginning a training routine.
- n Always warm-up before and cool down after exercising.
- n Move slowly during each exercise. Do not jerk or "throw" the weight.
- n Breathe freely. Do not hold your breath while lifting or lowering weight.
- n Hold moving arm/s and handles firmly, do not squeeze or grip tightly.
- n Structure each workout to exercise the largest muscles first. Suggested routines are found in the Nautilus Total Fitness Program.

n Experiment to find the exact weight you need for each exercise. Select a resistance that allows you to perform eight to twelve slow repetitions. Take two seconds to lift the weight. Pause briefly, and take four seconds to lower the weight.

General Maintenance

Frequency of maintenance is determined by several factors: temperature, humidity, use, ventilation and filtration, shielding and friction. External maintenance may vary from daily to monthly, internal maintenance from six months in a club environment to a year when used in a multi-user setting.

- 1. SPOT CHECK LOOSE NUTS AND BOLTS
 - A. Carefully check rotation points.
 - B. Tighten loose parts immediately. Also check for worn parts, seatbelts and upholstery pads.
- 2. UPHOLSTERY PAD TIGHTENING
 - Most bolts on upholstery pads can be tightened with a 9/16" combination wrench.
- 3. SHIELD REMOVAL
 - Some Nautilus® machines are equipped with quick-release shield fasteners. To remove Quick-Release shielding, gently pull shielding away from the frame. Use a proper screw driver to remove shield, which is attached to the frame with screws.
- 4. SHIELD INSTALLATION
 - Snap Quick-Release in place. Tighten screws only snugly. Use correct Phillips screw driver.

Lubrication

MOVING PARTS
To clean and lubricate guide rods, apply TFL #50 Wet Lubricant to a clean cloth then use to wipe rods.



*TFL 50 Wet Lubricant
Recommended for
Nautilus Machines.

WARNING
Do not lubricate MOVING PARTS.
May cause damage and VOID
WARRANTY.

Do not place equipment in
direct sunlight as ultra violet
rays can damage shields
and upholstery.

Cleaning

- 1. UPHOLSTERY CLEANING AND PROTECTION
 - A. Keep pads free of perspiration at all times.
 - B. Clean and disinfect upholstery at the end of each day, especially areas where perspiration and scalp oil collect.
 - C. Clean all outside surfaces with non-abrasive, non-chlorinated household cleaners. Virahol® Disinfectant Cleaner is an effective upholstery care product.
- 2. CLEANING AND CARE OF PAINTED SURFACES
 - A. Wipe painted surfaces with a damp cloth and car wax.
 - B. Let dry and buff with a dry cloth.

QUICK FILL A-33

Detergent/Disinfectant Odor Counteractant



An Outstanding liquid quaternary-based product for use in areas where there is heavy soiling. Provides the best odor counteraction available from a disinfectant. Available in ready-to-use; no mixing or dilution 16 oz. spray bottle. USDA Code 1, EPA Reg. 42964-

TO PLACE AN ORDER

Give our friendly Customer Service Representatives a call to order this product or any other Genuine Nautilus Parts
1-800-235-2233

PART
NUMBER
19-1175