

- 24 WEIGHT STACK
STANDARD
- REF # PART #200 lb. WEIGHT STACK (20-250)
- A01-0010BOLT HH 2 7/16-14 X 4 1/2 BLACK
- B02-91901/4-20 X 3/4 TROX PAN HEAD SCREW
- C03-1045NUT NTE 7/16 BLACK
- D04-5070RUBBER WEIGHT STACK WASHER
- E05-4020BOTTOM WEIGHT BUSHING
- F05-4055TOP WEIGHT BUSHING
- G06-7064COL SUPER 6"
- H06-8254SNAP RING 1"
- I07-4000NYLNER PLASTIC BUSHING
- J07-8296PN WEIGHT SELECTOR W MAGNET 4" LENGTH
- K07-9268TOP WEIGHT SLEEVE
- L12-1024DECAL WARNING 3"
- M12-1282WEIGHT STACK DECAL 20-310 lbs/kg
- N17-1615GUIDE RODS 74 13/16"
- O17-22041 X 4 X 9.330 TOP WEIGHT STEEL, 10 lbs.
- P17-22061 X 4 X 9.330 SECOND WEIGHT STEEL, 10 lbs.
- Q17-22031 X 4 X 9.330 BOTTOM WEIGHT STEEL, 10 lbs
- R17-4115WEIGHT STACK PN 24 HOLE
- S04-20151/4 -20 X 3/4 SAE FLAT WASHER

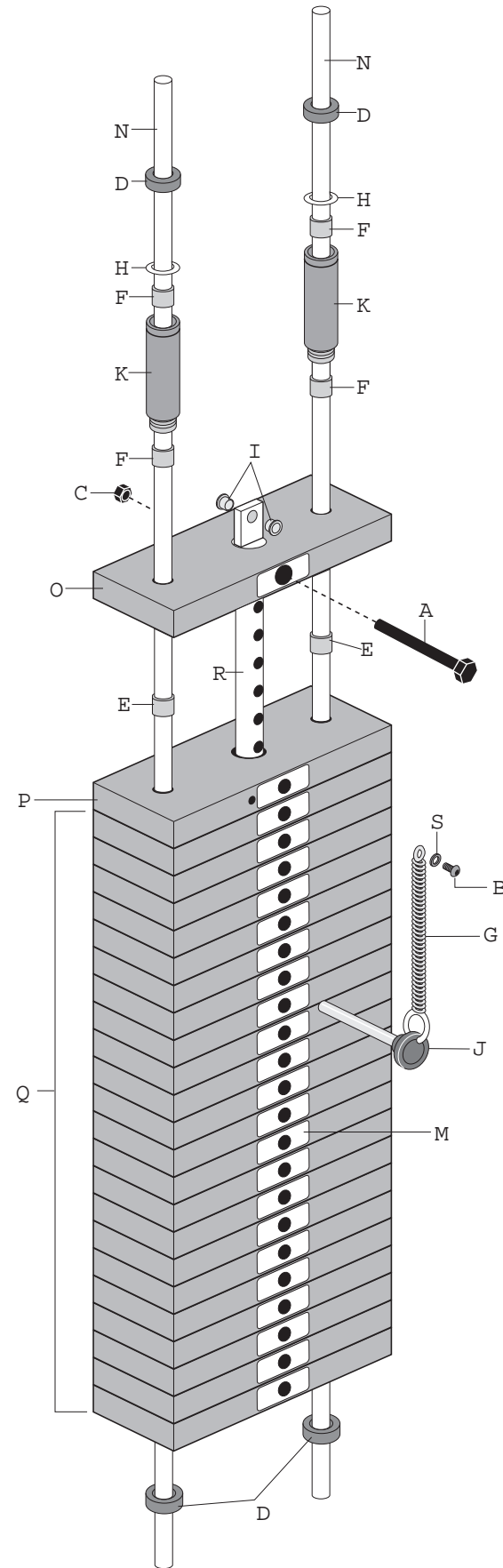

LAT PULLDOWN

19-5213

REVISED :
July 28, 2006

PARTS AND SERVICE

709 Powerhouse Road, Independence, VA 24348 800-235-2233 • Fax: 276-773-2298

F2LTP F2 LAT PULLDOWN

- | Ref # | Part # | Description |
|-------|---------|---|
| 1 | BF234 | MAN BACK FRAME |
| 2 | HB13 | HANDLEBAR ATTACHMENT |
| 3 | HB215 | PARALLEL LAT PULL BAR (29"W DE) |
| 4 | HB221 | PARALLEL LAT PULL BAR (19"W DE) |
| 5 | B210 | LAT PULL LEG BRACE ASSEMBLY |
| 6 | SF220 | LAT PULL SEAT FRAME |
| 7 | 01-1121 | BOLT HH 5 3/8 X 2 |
| 8 | 01-1151 | BOLT HH 5 3/8 X 2 3/4 |
| 9 | 01-1331 | BOLT HH 5 1/2 X 2 3/4 |
| 10 | 01-1351 | BOLT HH 5 1/2 X 3 1/4 |
| 11 | 01-1381 | BOLT HH 5 1/2 X 4 |
| 12 | 02-4170 | SET SCREW 10-32 X 1/2 |
| 13 | 02-9220 | BOLT HH 5 3/8 X 1 1/4 |
| 14 | 03-1035 | 3/8 NUT FLANGE BLACK |
| 15 | 03-1055 | 1/2-13 FLANGE NUT BLACK |
| 16 | 03-4142 | NUT JAM 5/16 BLACK |
| 17 | 04-5207 | 1/2 SAE FLAT WASHER |
| 18 | 04-5213 | 3/8 NT LOCK WASHER BLACK |
| 19 | 04-5214 | 1/2 NT LOCK WASHER BLACK |
| 20 | 05-1080 | BRASS BUSHING .750 X 1 X 1 |
| 21 | 06-2140 | SAFETY CHAIN (6 LINKS) |
| 22 | 06-4062 | CABLE ASSY F2LTP 3/16"W RE X 85 1/2"L |
| 23 | 06-5020 | SAFETY HOOK SPRING LOADED |
| 24 | 06-7046 | CABLE WEIGHT STACK BRACKET 14GA |
| 25 | 06-7047 | CABLE END BRACKET 14GA |
| 26 | 06-8258 | INTERNAL SNAP RING 5/8 ,N5000-62 |
| 27 | 06-8285 | 1 3/4 IN. EXT. SNAP RING 5108-177 BLACK ZNC |
| 28 | 07-7000 | 3/16 X 1 ROLL PIN |
| 29 | 07-8281 | PN SELECTOR 1/2 DIA CR X 3.81"L |
| 30 | 07-8332 | LAT PULL SELECT TUBE 2" SQ (77 11/32 L) |
| 31 | 07-8368 | ALUM. PULLEY SPACERS |
| 32 | 07-9112 | WORKBOX UPPER F2LTP SHEETMETAL |
| 33 | 07-9220 | LAT PULLDOWN BAR (BEND) 1"D X 120 W |
| 34 | 07-9230 | LAT PULLDOWN BAR 3/4 DURO ROD 13 1/2"L |
| 35 | 07-9286 | SLIDE CAP PLASTIC FOR 2" SQ TUBE |
| 36 | 08-5185 | SPACER |
| 37 | 09-1095 | GRP 1" D X 4 1/2" LONG BLACK PLASTIC |
| 38 | 09-1145 | GRP FOAM 938" X 21" OPEN END |
| 39 | 09-2060 | PLUG, FRAME, 1-1/2 X 3 |
| 40 | 09-2090 | PLUG, FRAME, 2X3 |
| 41 | 09-3065 | 9/16 DIA HOLE PLUG WHITE |
| 42 | 09-3090 | 1 3/4 OD X 1 3/8 D MOLDED HOLE PLUG |
| 43 | 09-5030 | FOOT PAD, ROUND |
| 44 | 09-5035 | MOLDED FOOTPADS |
| 45 | 09-8051 | GRP CAP 1 1/8" D |
| 46 | 09-8146 | SELECTOR PIN TP |
| 47 | 09-8135 | YELLOW T-KNOB |
| 48 | 09-8322 | 6" PULLEY |
| 49 | 10-2030 | SPRING COMPRESSDN 490 OD X 2.375"L |
| 50 | 12-1026 | KEEP HANDS AWAY DECAL |
| 51 | 12-1074 | DECAL SEAT 3/4" INCREMENTS 1-11 BLACK |
| 52 | 12-1185 | NAUTILUS DECAL NEW LOGO |
| 53 | 19-1110 | PANT SPRAY CAN 16 oz. |
| 54 | 19-5213 | PARTS MANUAL F2LTP |
| 55 | 30-2120 | BUSHING UPH .178 X 3 3/8 X 1 1/4 |
| 56 | JP9838 | LAT BAR UPH. PAD |
| 57 | JP9839 | LAT BAR UPH. PAD (1' x 1' notch) |
| 58 | JP9955 | ROLLER PAD 8" LONG |
| 59 | JP9915 | SEAT PAD |

- | Ref # | Part # | Description |
|-------|---------|------------------------------------|
| 60 | 12-1380 | INSPECTION STICKER DECAL |
| 61 | 12-5611 | NAUTILUS NAMEPLATE 1 1/2 x 8 1/2 L |
| 62 | 19-1291 | DECAL SERIAL # BAR CODE |
| 63 | 40-7167 | BAG 50 X 46 X 86 X .002 THICK |



USE CAUTION
WHEN WORKING
WITH WEIGHT
STACK !

RED : PAINTED ITEMS
 _____ Trolleys / Machine

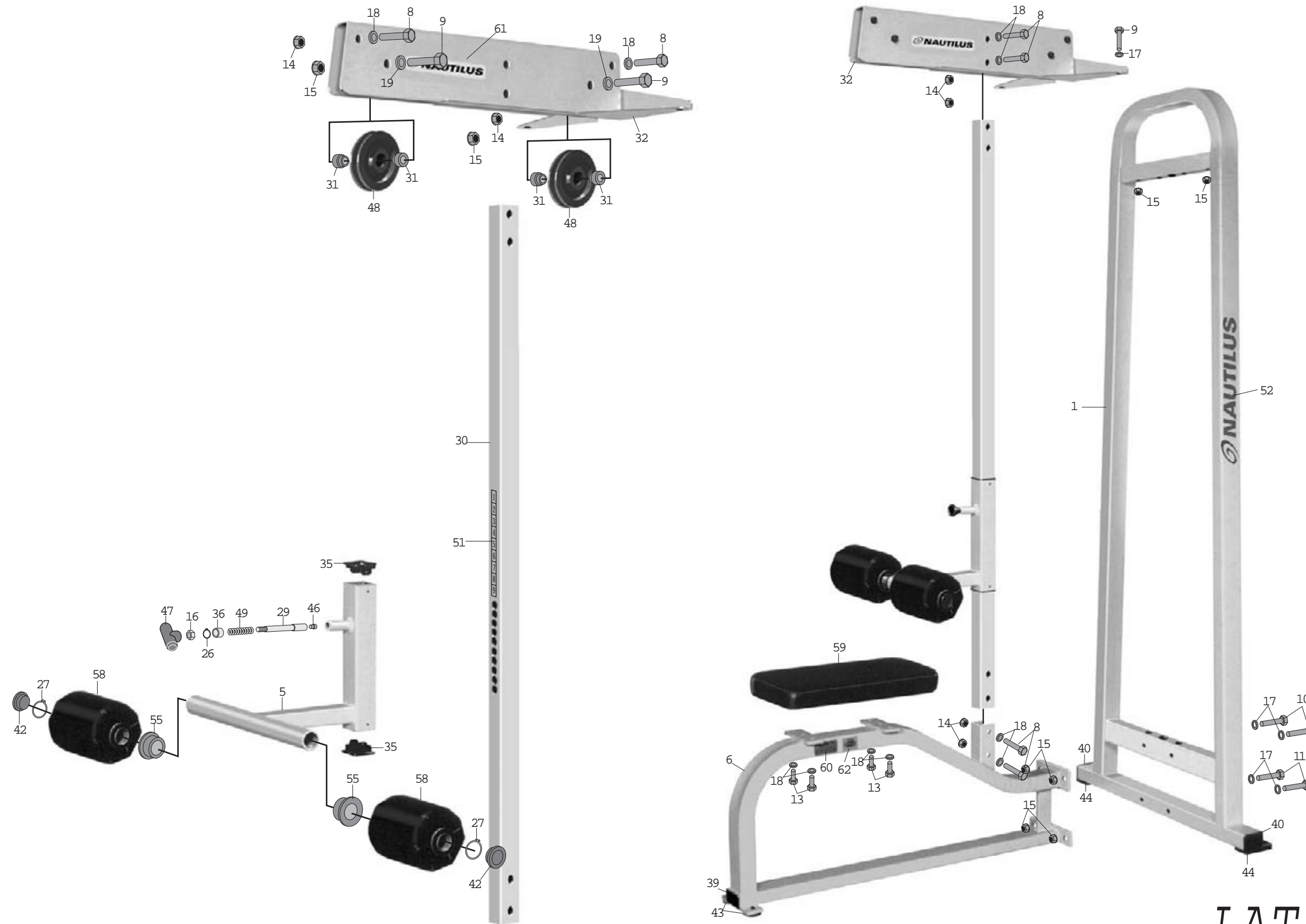

F2LATP
LAT PULLDOWN
 Nautilus Parts Diagram

RED : PAINTED ITEMS
____ Trolleys / Machine

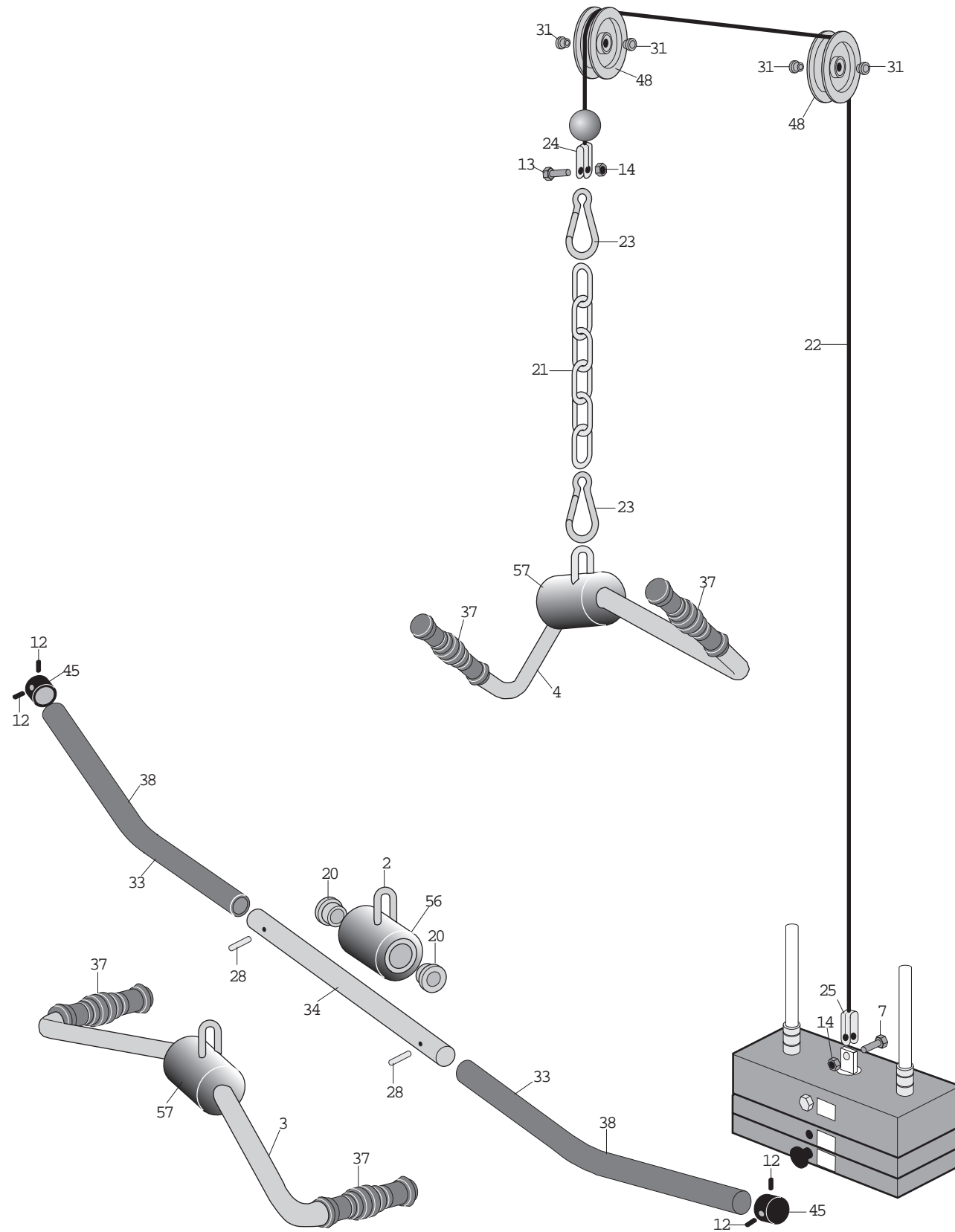

Last Rev Date: 07/28/06

F2LATP
LAT PULLDOWN
Nautilus Parts Diagram



Warranty Information

Nautilus® Free Weight Warranty Limited Warranty Terms & General Specifications

Nautilus warrants only to the original purchaser that Nautilus® exercise equipment from the manufacturer is free from defects in material and workmanship under normal use and service. Our obligation under this warranty shall be limited to the repair or exchange at our plant (a) of any part or parts of the structural frame, moving weldments or weight stacks which may thus prove defective under normal use and service for 12 years from delivery to the original purchaser; (b) of any moving part or parts not otherwise disclosed within this warranty which thus may prove defective under normal use and service within one (1) year from delivery to the original purchaser; and (c) of any upholstery, pads, grips or tethered weight pin connectors which thus may prove defective under normal use and service within 120 days from delivery to the original purchaser. This warranty only applies to those parts that our own examination discloses to our satisfaction to be thus defective.

This warranty is expressly in lieu of all other warranties, express or implied, including the warranties of merchantability and fitness for use and of all other obligations or liabilities on our part, and we neither assume nor authorize any other person to assume for us any other liability in connection with the sale of this NAUTILUS® exercise equipment. This warranty shall not apply to this NAUTILUS® exercise equipment or to any part thereof which has been subject to accident, negligence, alteration, abuse, misuse, or a lack of maintenance in accordance with our recommended maintenance instructions.

We make no warranty whatsoever in respect to accessories or parts not manufactured by us and disclaim all warranties, express or implied, as to such accessories and parts. The term “original purchaser”, as used in this warranty, shall be deemed to mean that person or entity for whom this NAUTILUS® exercise equipment is originally installed. This warranty shall apply only within the boundaries of the continental United States.

NAUTILUS® shall not be liable for any loss or damage, including incidental or consequential damages resulting directly or indirectly from the use or loss of use of our NAUTILUS® exercise equipment. Without limiting the generality of the foregoing, this exclusion from liability embraces the purchaser’s expenses for downtime or for making up downtime, damages for which the purchaser may be liable to other persons, damages to property, and injury to or death of any persons. We neither assume nor authorize any person to assume for us any liability in connection with sale or use of our equipment. There are no oral agreements or warranties collateral to or affecting this agreement.

WARNING

Store indoors only. Do not subject machine to high humidity or damp conditions.



NAUTILUS[®] Maintenance

For Free Weight Support Line



Getting maximum results from Nautilus[®] machines depends on proper maintenance of equipment.

Welcome

Congratulations on choosing Nautilus[®] Free Weight strength training equipment. The addition of several exciting new features to the Nautilus[®] line, as outlined in these instructions, ensures that your equipment will operate with little scheduled maintenance. We know this is important to you and your customers, so please take a few minutes to read the following instructions for keeping your Nautilus[®] equipment in the best working condition.

Contents

Welcome	1
Parts & Service	2
Safety/Before Exercising	2
Maintenance Schedule	2
General Maintenance	2
Cleaning.....	3
Lubrication	3
Hydraulic Unit Adjustment.....	3
Warranty Information	4

Parts & Services

Regular and scheduled maintenance will prolong the life of your Nautilus equipment. Should you have to replace parts, use only genuine Nautilus parts. The Nautilus Customer Service Team invites you to call in your order for replacement parts. They're never too busy to discuss or offer a tip on your maintenance tasks.

Nautilus machines -- the culmination of years of research and refinement -- are made from the highest quality materials, under exacting conditions. The quality control tag attached to each machine before shipping ensures that each unit has been thoroughly inspected to meet Nautilus' strict requirements.

Should you, the owner of a Nautilus machine, need to replace any parts because of normal wear and tear, or should your machine ever need maintenance, Nautilus invites you to call our Virginia Headquarters office for information on parts and service.

Nautilus has available: detailed isometric drawings on the website @ www.nautilus.com for each machine manufactured, genuine Nautilus Upholstery Pads, Naugahyde[®] Spray Cleaner/Conditioner recommended for Nautilus upholstery pads and TFL #50 Wet Lubricant recommended for the care of the guide rods of Nautilus selectorized resistance machines.

Nautilus' concern for the customer does not end with the purchase of equipment. Your comments are always welcomed. In the unlikely event that a problem occurs, call us toll free:



**Nautilus
Customer
Service**

**1-800-235-2233
Fax: 276-773-2298**

Safety

1. Supervision is necessary when the machine is used by or near children, invalids, or disabled persons.
2. Follow the instructions for specific exercises on each machine
3. Get in and out of the equipment carefully.
4. Never operate the machine without shields in place.
5. Use only Nautilus selector pins in weight stack. Never drop or insert any other object into machine opening.
6. Use this machine only as intended or described in this manual.
7. Do not operate equipment with loose or damaged parts. If machine fails to operate correctly, do not attempt to repair. Notify authorized personnel of the problems.
8. Keep hands and feet clear of weights and other moving parts when in use. Keep hands and feet only on the hand grips and foot pads provided.
9. Failure to comply with these instructions may result in personal injury.

CAUTION

Stop exercising immediately if you experience a sharp nerve or joint pain, and seek medical advice.

Before Exercising

To guard against injury, all equipment users should follow these instructions.

- Check with your physician and get approval before beginning a training routine.
- Become familiar with the equipment before beginning a training routine.
- Always warm-up before and cool down after exercising.
- Move slowly during each exercise. Do not jerk or "throw" the weight.
- Breathe freely. Do not hold your breath while lifting or lowering weight.
- Hold movement arms and handles firmly, do not squeeze or grip tightly.
- Structure each workout to exercise the largest muscles first. Suggested routines are found in the Nautilus Total Fitness Program.
- Experiment to find the exact weight you need for each exercise. Select a resistance that allows you to perform eight to twelve slow repetitions. Take two seconds to lift the weight. Pause briefly, and take four seconds to lower the weight.

Maintenance Schedule

	DAILY	WEEKLY	MONTHLY	EVERY 6 MONTHS
General Maintenance				
Check Safety & Warning Decals	■			
Spot Check Belt _____				■
Spot Check Nuts and Bolts _____				■
Spot Check All Pegs and Stops _____				■
Examine Rotation Points _____				■
Cleaning				
Clean Upholstery _____	■			
<i>Use Nautilus Disinfectant Cleaner.</i>				
Clean Surface Area _____		■		
Remove Dust _____				■
Lubrication				
Lubricate and Clean Guide Rods Using TFL 50 _____		■		
<i>Do not lubricate hydraulic cylinders.</i>				

General Maintenance

Frequency of maintenance is determined by several factors: temperature, humidity, use, ventilation and filtration, shielding and friction. External maintenance may vary from daily to monthly, internal maintenance from six months in a club environment to a year when used in a multi-user setting.

1. SPOT CHECK LOOSE NUTS AND BOLTS

- Carefully check rotation points.
- Tighten loose parts immediately. Also check for worn parts, seat belts and upholstery pads.

2. UPHOISTERY PAD TIGHTENING

Most bolts on upholstery pads can be tightened with a 9/16" combination wrench.

3. SHIELD REMOVAL

Some Nautilus® machines are equipped with quick-release shield fasteners. To remove Quick-Release shielding, gently pull shielding away from the frame. Use a proper screwdriver to remove shield, which is attached to the frame with screws.

4. SHIELD INSTALLATION

Snap Quick-Release in place. Tighten screws only snugly. Use correct phillips screwdriver.

Lubrication

MOVING PARTS

- To clean and lubricate guide rods, apply TFL#50 Wet Lubricant to a clean cloth then use to wipe rods.



PART NUMBER
19-1160

*TFL 50
Wet
Lubricant

Recommended
for Nautilus
Machines.

Cleaning

1. UPHOLSTERY CLEANING AND PROTECTION

- Keep pads free of perspiration at all times.
- Clean and disinfect upholstery at the end of each day, especially areas where perspiration and scalp oil collect.
- Clean all outside surfaces with non-abrasive, non-chlorinated household cleaners. Virahol® Disinfectant Cleaner is an effective upholstery care product.

2. CLEANING AND CARE OF PAINTED SURFACES

- Wipe painted surfaces with a damp cloth and car wax.
- Let dry and buff with a dry cloth.

3. CLEANING AND CARE OF ABS PLASTIC SHIELDING

- Clean with non-abrasive, non-chlorinated household cleaners.
- Vacuum or wipe dust from recessed areas and surfaces.

QUIK FILL® 33 Detergent/Disinfectant Odor Counteractant



PART NUMBER
19-1175

An Outstanding liquid quaternary-based product for use in areas where there's heavy soiling. Provides the best odor counteraction available from a disinfectant. Available in ready-to-use; no mixing or dilution 16 oz. spray bottle. USDA Code 1, EPA Reg. 42964-

TO PLACE AN ORDER
Give our friendly Customer Service Representatives a call to order this product or any other Genuine Nautilus Parts

1-800-235-2233



709 Powerhouse Road ♦ Independence, VA 24348

Do not place equipment in direct sunlight as ultra violet rays can damage shields and upholstery.