



OWNER'S MANUAL

FREE WEIGHT CHIN/DIP

Contents

Parts Manual

- 1 FRAME ASSEMBLY
 - 2 PARTS LIST
-

Maintenance Manual

Follows page 2

See last pages of this manual for Sample Training Record.

REVISED: July 19, 1999

SERIAL NO.'S

through

PARTS AND SERVICE

709 Powerhouse Road
Independence, VA 24348
800-235-2233 • Fax: 540-773-2298

F2CD



19-5216

Nautilus
FREE WEIGHT
CHIN/DIP

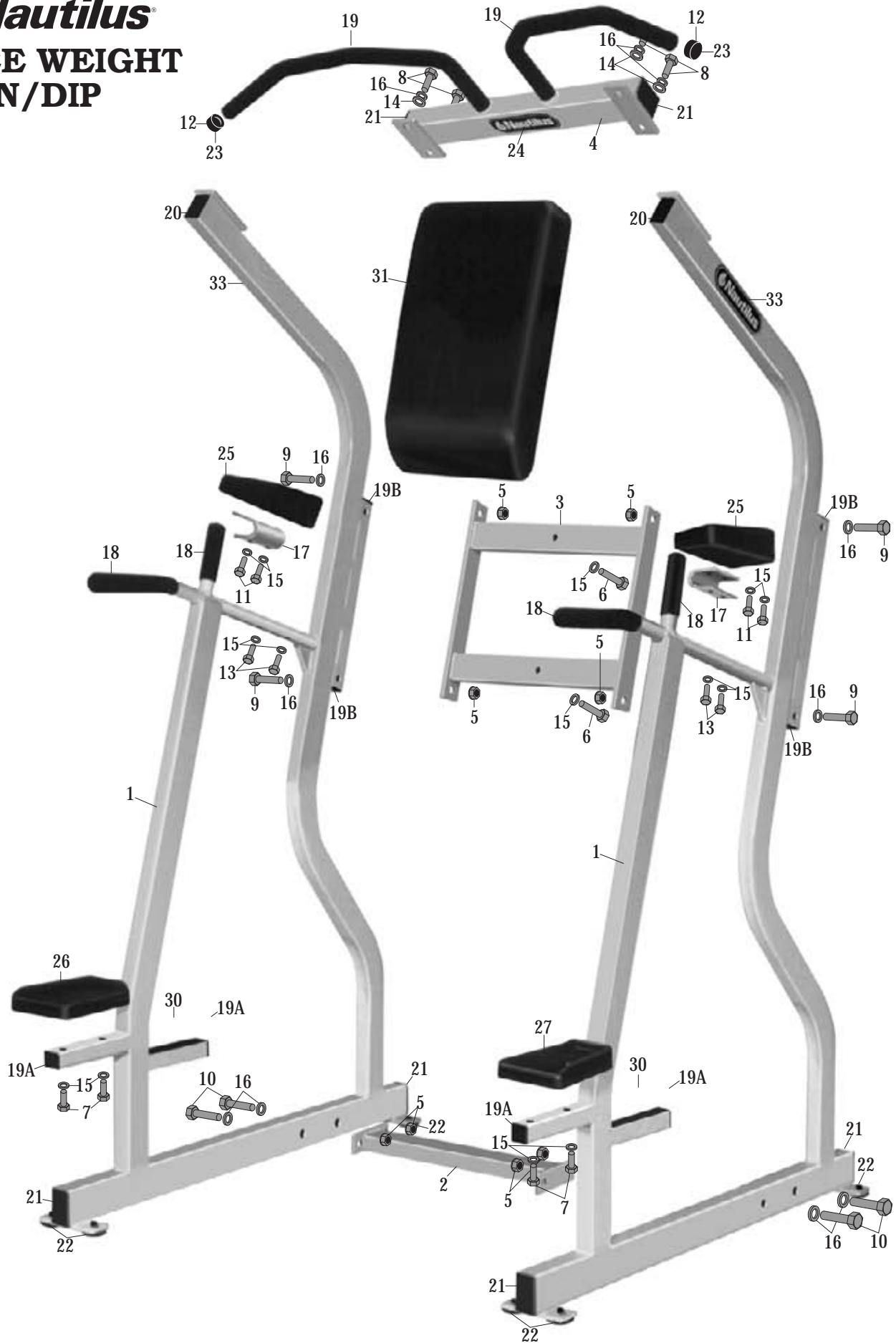



F2CD
FREEWEIGHT CHIN - DIP

Ref #	Part #	Description
1	BSF221	F2CD SIDE FRAME
2	CM233	F2CD LOWER CROSSMEMBER
3	CM234	UPPER CROSSMEMBER
4	HB217	F2CD HANDLE
5	01-1055	1/2 NUT
6	01-1115	3/8 X 2 1/2 BOLT - BACK PAD
7	01-1121	3/8 X 2 BOLT - FOOTPAD
8	01-1261	1/2 X 1 BOLT - HANDLES
9	01-1321	1/2 X 2 1/2 BOLT - UPPER CROSSMEMBER
10	01-1331	1/2 X 2 3/4 BOLT - LOWER CROSSMEMBER
11	01-1546	3/8 X 3/4 BOLT - ELBOW PAD
12	02-4170	10-32 x 1/8 SET SCREW
13	02-9210	3/8 X 1 BOLT - ELBOW MOUNT
14	04-5207	1/2 SAE FLAT WASHER
15	04-5213	3/8 LOC WASHER
16	04-5214	1/2 LOC WASHER
17	07-5167	ELBOW ANGLE MOUNTS
18	09-1105	1 1/8 X 5 GRIPS
19	09-1150	1 1/8 X 33 HOSE GRIPS (FOR 1 1/4 BAR - CUT TO 29")
19A	09-2020	1 1/2 SQ. HOLE PLUG
19B	09-2040	1 1/2 X 2 HOLE PLUG
20	09-2060	1 1/2 X 3 HOLE PLUG
21	09-2090	2 X 3 HOLE PLUG
22	09-5030	ROUND FOOTPADS
23	09-8049	1 1/4 GRIP ENDCAPS
24	12-1088	DECAL NAUTILUS NAMEPLATE 2 1/2 x 9 1/4 long
25	14-6305	MOLDED ELBOW PAD
26	14-6321	LEFT MOLDED FOOTPAD
27	14-6322	RIGHT MOLDED FOOTPAD
28	19-1110	PAINT SPRAY CAN 16 oz.
29	19-5216	PARTS MANUAL F2CD
30	48-1095	3" TREADSTRIP (EACH PIECE 7 1/2" X 3")
31	UP8000	SEAT PAD
	IN02	INSPECTION KIT
32	12-1080	INSPECTION STICKER DECAL
33	12-1089	NAUTILUS NAMEPLATE 1 1/2 x 6 1/4 L PLASTIC
34	19-1291	DECAL SERIAL # BAR CODE
35	40-7167	BAG 50 X 46 X 86 X .002 THICK