

REVISIONS				
REV	DATE	DESCRIPTION	ECO	BY
A	9/2/2008	RELEASE FOR PRODUCTION	100387	EMS
B	11/3/2008	REPLACED WGT STACK 2310-0140 WITH CORRECT WGT STACK 2310-0140	100348	EMS

ITEM NO	PART NUMBER	DESCRIPTION	QTY
1	2211-0107	ASSY WELD MAIN FRAME PR-S430A	1
2	2211-0077	ASSY WELD WGT FRAME PR-S430A	1
3	2210-0963	ASSY WELD ROM ADJ LH PR-S430A	1
4	2210-0964	ASSY WELD ROM ADJ RH PR-S430A	1
5	2210-0108	ASSY WELD SEAT #1	1
6	2211-0079	ASSY WELD HANDLE PR-S430A	2
7	2130-0064	PLATE KICK PLATE	1
8	2310-0140	ASSY W STK 10TSLB204LBS PULLEY TALL	1
9	3500-0025	ASSY UPHOLSTERY 13 7/8 X 8 7/8 FC-202-C	1
10	3500-0048	ASSY UPHOLSTERY 10X30FS-401-A	1
11	3500-0124	ASSY UPH HEAD PAD S430A	1
12	1400-0001	TUBE ROUND 927 I.D X 1.25 RUBBER BLK	28 IN
13	2130-0953	BAR MACH 3/4X90 X 2 TYP GRACE	2
14	2130-0969	BRACKET MOUNT KICK PLATE IMPACT	2
15	2200-0031	CONTACT PAD ROM S430A	2
16	2200-0032	CONTACT PAD HANDLE S430A	2
17	2210-0001	SHROUD UPPER PRO	2
18	2210-0002	SHROUD LOWER LONG INSIDE PRO	1
19	2210-0004	SHROUD LOWER LONG OUTSIDE PRO	1
20	2210-0009	BUSHING SEAT POST	1
21	2211-0108	ASSY WELD ROM RIGHT PEC / DELT	1
24	2211-0109	ASSY WELD ROM LEFT PEC / DELT	1
25	2290-0001	ASSY WELDMENT HANDLE	1
26	1161-0074	SCREW #8 18x1 1/2 PHF 48 PHCS	14
27	4230-0005	BHSCS 3/8-20 X 1/2	3
28	4230-0033	BHSCS 3/8-16 X 1 1/8 BLK Z	2
29	4230-0051	BHSCS 3/8-16 X 2 1/2 BRIGHT Z	1
30	4230-0052	BHSCS 3/8-16 X 3 1/4 BRIGHT Z	2
31	4230-0057	BHSCS 3/8 X 2 1/4 BRIGHT Z	10
32	4230-0059	BHSCS 3/8-16 X 4 1/4 BRIGHT Z	2
33	4230-0069	BHSCS 1/4-20 X 1 3/4 BRIGHT Z	1
34	4230-0083	BHSCS 5/16-18 X 1 1/4 BRIGHT Z	4
35	4230-0085	BHSCS 5/16-18 X 3.0 BRIGHT Z	4
36	4230-0104	BHC 3/8-16 1.5 SHC AS BZ	6
37	4230-0105	BHC 1/2-20 2.5 SHC AS BZ	2
38	4230-0013	HV SHCS 0.25-20x 79x1 25-5	1
39	4230-0029	SHCS 1/2-20 X 2 Z	2
40	4250-0001	SSS 10-32 X 1 1/8 BLK	8
41	4500-0002	NUT NYLOC 5/16-18	4
42	4500-0008	NUT JAM 1/4-20 Z	1
43	4500-0009	NUT JAM NYLOC 3/8-16 NTE	11
44	4500-0018	NUT NYLOC 3/8-16 BLK Z	2
45	4500-0029	NUT NYLOC JAM 3/8-16 Z	5
46	4500-0046	U NUT #8 PANEL 125-125	14
47	4600-0048	U NUT 1/4-20 EDGE 20 125-150	2
48	4600-0001	WASHER 5/16	12
49	4600-0008	WASHER SAE 1/2 Z	2
50	4600-0009	WASHER SAE 3/8-16 Z	30
51	4800-0001	BELT MECTROL SPOOL	195 IN
52	4900-0001	STOP RED	2
53	4900-0005	CAP HANDLE T CHROME	4
54	4900-0026	BEARING FLANGE 750H X 750H	4
55	4900-0037	BEARING FLANGE 1.00X 1.00H	4
56	4900-0052	SPRING O.D 5.115 CENTURY 921	1
57	4900-0056	PIN PULL CAM BELT	2
58	4900-0057	CAM PIN CLAMP CABLE	2
59	4900-0058	CLAMP CAM BELT	2
60	4900-0062	2 BOLT FLANGE MOUNT BEARING	4
61	4900-0080	CAM WRC-18	2
62	4900-0088	CAP BLACK T ROUND	2
63	4900-0108	SLEEVE HANDLE RED	1
64	4900-0101	PULL PIN 1/2 X 200	2
65	4900-0140	PULLEY BELT 4 750 3/8 1.5W MOLDED	2
66	4900-0441	PULLEY BELT 4 750 1/2 1.5W MOLDED	2
67	5210-0105	PLAC IMPACT PR-S430A PEC DELT FLY	1
68	5220-0005	LABEL SAFETY SECURE TO FLOOR	1
69	5220-0023	LABEL SAFETY MAIN WARNING IMPACT	1
70	5230-0008	LOGO 3 TANK TRAC IMPACT TOP SHROUD	2
71	5230-0009	LOGO IMPACT LOWER SHROUD	1
72	5230-0035	LABEL NAME BELT FLY	1

NOTES:

1. INTERPRET DRAWING PER ASME Y14.5M-1994
2. REMOVE ALL BURRS AND SHARP EDGES: 0150-0300.
3. IF APPLICABLE CRITICAL DIMENSIONS LABELED.
4. ALL HARDWARE TO BE KITTED PER 3700-0387.
5. ALL UPHOLSTERY TO BE KITTED PER 3700-0382.

DOCUMENT STATUS:
RELEASED

MATERIAL
SEE BOM

FINISH
N/A

THIS DOCUMENT SHALL NOT BE REPRODUCED NOR SHALL THE INFORMATION CONTAINED HEREIN BE USED IN OR DISCLOSED TO OTHERS WITHOUT THE EXPRESS AUTHORIZATION BY UNISEN.

UNISEN, INC. DBA 14410 Milled Road Irvine CA 92606	
DRAWN BY: MS CHECKED BY: MS APPROVED BY: MS	DATE: 8/29/2008 PART NUMBER: 9PR-S430AXXXXX DESCRIPTION: PEC DELT FLY, PR SCALE: 1:8 SHEET 2 OF 2 SHEET SIZE: D

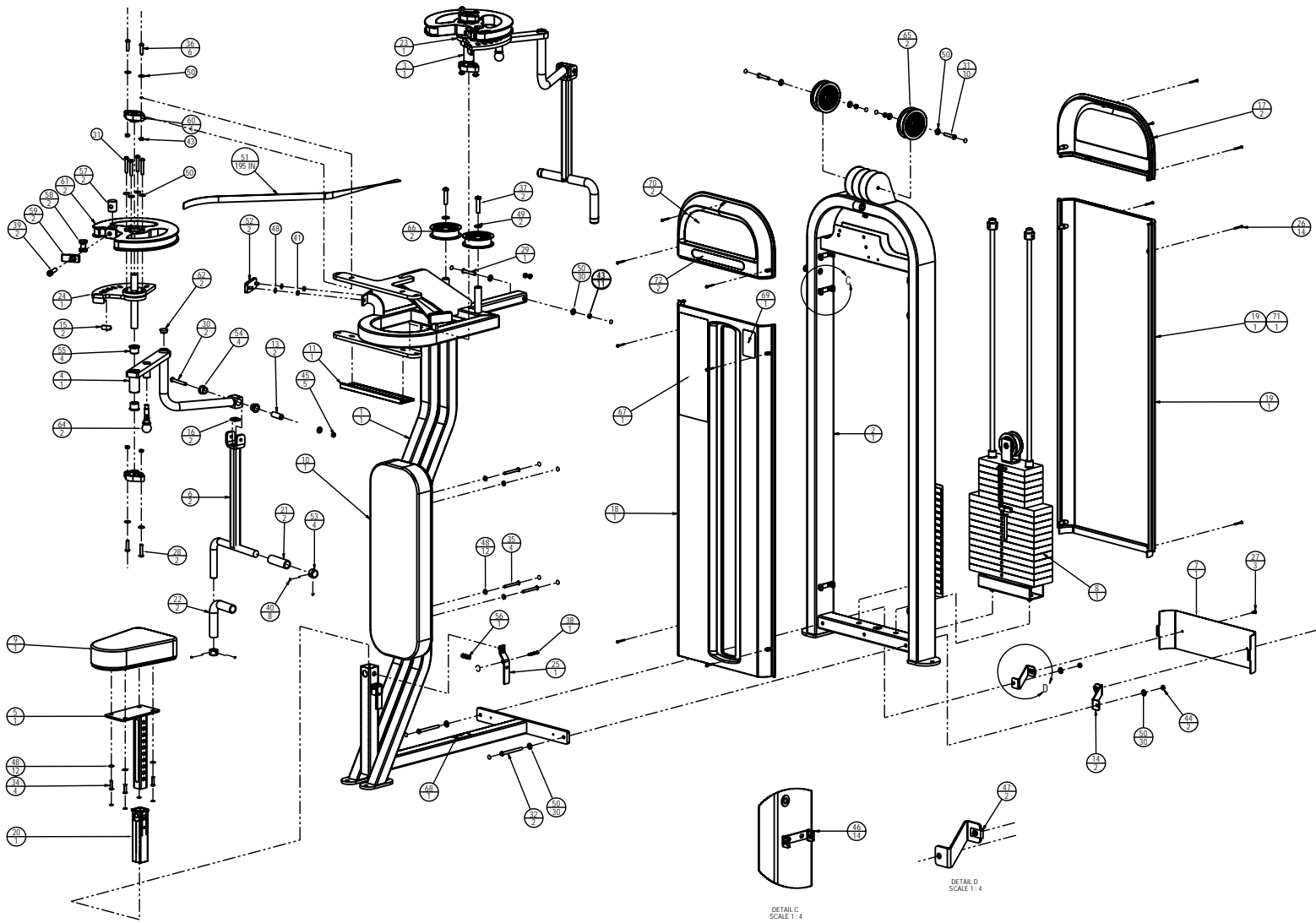

DETAIL C
SCALE 1:4

DETAIL D
SCALE 1:4

UNISEN, INC. DBA STAR TRAC	14410 Myford Street Irvine, CA 92606
9PR-S4304AXXXX	B
PEC/DELT FLY, PR	
SCALE: 1:8	SHEET 2 OF 2 SHEET SIZE: B