

NAUTILUS FREEWEIGHT PARTS DIAGRAM

OLYMPIC DECLINE BENCH 19-5186

REVISED:
Dec. 18, 2006

PARTS AND SERVICE ♦ 709 Powerhouse Road Independence, VA 24348
800-235-2233 • Fax: 276-773-2298

F20DB OLYMPIC DECLINE BENCH

Ref #	Part #	Description
1	BF226	BACK FRAME DECLINE BENCH
2	CM221	FW CROSSMEMBER ASSEMBLY
3	09-9212	STAINLESS STEEL .120 X 3 X 27 3/4 LEFT
4	09-9213	STAINLESS STEEL .120 X 3 X 27 3/4 RIGHT
5	12-5600	NEW NAUTILUS NAMEPLATE 1 1/2 x 8 1/2 L
6	01-1381	BOLT HH5 1/2 X 4 BLACK
7	02-4100	1/4 X 1/2 AHC SCREW
8	02-9210	3/8-16 X 1 HH5 BOLT
9	03-1055	FL NUT 1/2 -13 BLACK
10	04-5207	1/2 USS WASHER BLACK
11	04-5206	3/8 SAE FLAT WASHER
12	07-5489	WEIGHT STORAGE BAR, 20"
13	07-5832	WEIGHT STORAGE BAR, 11 5/8"
14	09-2090	PLUG, FRAME, 2X3
15	09-4066	WEIGHT STORAGE, 3/4 X 3" OD RUBBER
16	09-5035	RECTANGULAR FOOT PADS
17	09-9060	SLEEVE, BAR STORAGE
18	19-1014	DOUBLE SIDED TAPE 2" (42")
19	SF222	SEAT FRAME ASSEMBLY
20	SF223	TELESCOPING FOOT ANCHOR
21	02-4129	1/4 X 1/4-20 SET SCREW

Ref #	Part #	Description
22	02-9220	BOLT HH5 3/8 X 1 1/4 (UPH.)
23	03-4142	NUT JAM 5/16 BLACK
24	04-5213	WASHER, 3/8 LOCK, BLACK (UPH.)
25	06-8230	SNAP RING EXTERNAL, 1" THIN 5100-100
26	07-8291	PIN SELECTOR 1/2 DIA X 7 9/16 L ZINC PLATED
27	07-9286	END SLIDES
28	07-9287	TUBE PLUG / SLIDE
29		OMIT
30	09-2040	PLUG, FRAME 1 1/2 SQ.
31	09-2070	PLUG, FRAME 2" SQ.
32	09-2085	PLUG, FRAME 2 1/2 SQ.
33	09-3074	HOLE PLUG 3/4 DIA BLACK
34	09-5030	FOOTPADS MOLDED ROUND
35	09-8146	SELECTOR PIN TIP
36	09-8275	KNOB SELECTOR PIN
37	10-3070	SPRING FL .042 X 1/2 OD X 4
38	12-1074	DECAL SEAT 3/4" INCREMENTS 1-11 BLACK
39	UP8070	ROLLER PAD 4 1/2" X 8" L
40	UP9055	SEAT / BACK PAD
41	01-1321	BOLT HH5 1/2 X 2-1/2 BLACK
42	19-5186	DIAGRAM PARTS F20DB
43	12-1380	DECAL INSPECTION
44	08-2056	SPACER NYLON 1 ID 1 1/4 ODL1/4-17W18500-B
45	UP714	SLIPCOVER 2BP (OPTIONAL)



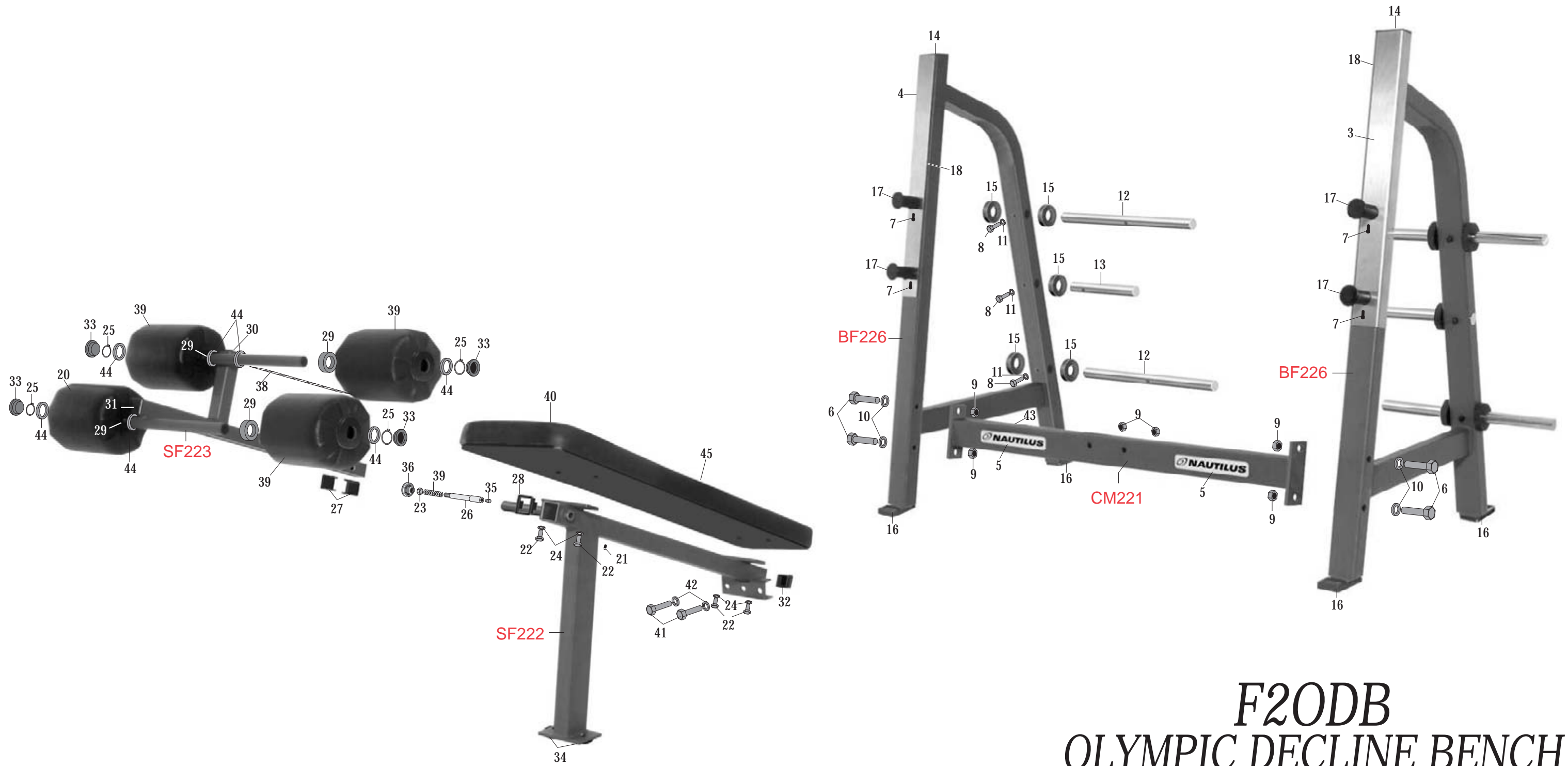

Last Rev Date: 12/18/06

F20DB
OLYMPIC DECLINE BENCH
Nautilus Parts Diagram



Warranty Information

Nautilus® Free Weight Warranty Limited Warranty Terms & General Specifications

Nautilus warrants only to the original purchaser that Nautilus® exercise equipment from the manufacturer is free from defects in material and workmanship under normal use and service. Our obligation under this warranty shall be limited to the repair or exchange at our plant (a) of any part or parts of the structural frame, moving weldments or weight stacks which may thus prove defective under normal use and service for 12 years from delivery to the original purchaser; (b) of any moving part or parts not otherwise disclosed within this warranty which thus may prove defective under normal use and service within one (1) year from delivery to the original purchaser; and (c) of any upholstery, pads, grips or tethered weight pin connectors which thus may prove defective under normal use and service within 120 days from delivery to the original purchaser. This warranty only applies to those parts that our own examination discloses to our satisfaction to be thus defective.

This warranty is expressly in lieu of all other warranties, express or implied, including the warranties of merchantability and fitness for use and of all other obligations or liabilities on our part, and we neither assume nor authorize any other person to assume for us any other liability in connection with the sale of this NAUTILUS® exercise equipment. This warranty shall not apply to this NAUTILUS® exercise equipment or to any part thereof which has been subject to accident, negligence, alteration, abuse, misuse, or a lack of maintenance in accordance with our recommended maintenance instructions.

We make no warranty whatsoever in respect to accessories or parts not manufactured by us and disclaim all warranties, express or implied, as to such accessories and parts. The term “original purchaser”, as used in this warranty, shall be deemed to mean that person or entity for whom this NAUTILUS® exercise equipment is originally installed. This warranty shall apply only within the boundaries of the continental United States.

NAUTILUS® shall not be liable for any loss or damage, including incidental or consequential damages resulting directly or indirectly from the use or loss of use of our NAUTILUS® exercise equipment. Without limiting the generality of the foregoing, this exclusion from liability embraces the purchaser’s expenses for downtime or for making up downtime, damages for which the purchaser may be liable to other persons, damages to property, and injury to or death of any persons. We neither assume nor authorize any person to assume for us any liability in connection with sale or use of our equipment. There are no oral agreements or warranties collateral to or affecting this agreement.

WARNING

Store indoors only. Do not subject machine to high humidity or damp conditions.



NAUTILUS[®] Maintenance

For Free Weight Support Line



Getting maximum results from Nautilus[®] machines depends on proper maintenance of equipment.

Welcome

Congratulations on choosing Nautilus[®] Free Weight strength training equipment. The addition of several exciting new features to the Nautilus[®] line, as outlined in these instructions, ensures that your equipment will operate with little scheduled maintenance. We know this is important to you and your customers, so please take a few minutes to read the following instructions for keeping your Nautilus[®] equipment in the best working condition.

Contents

Welcome	1
Parts & Service	2
Safety/Before Exercising	2
Maintenance Schedule	2
General Maintenance	2
Cleaning.....	3
Lubrication	3
Hydraulic Unit Adjustment.....	3
Warranty Information	4

Parts & Services

Regular and scheduled maintenance will prolong the life of your Nautilus equipment. Should you have to replace parts, use only genuine Nautilus parts. The Nautilus Customer Service Team invites you to call in your order for replacement parts. They're never too busy to discuss or offer a tip on your maintenance tasks.

Nautilus machines -- the culmination of years of research and refinement -- are made from the highest quality materials, under exacting conditions. The quality control tag attached to each machine before shipping ensures that each unit has been thoroughly inspected to meet Nautilus' strict requirements.

Should you, the owner of a Nautilus machine, need to replace any parts because of normal wear and tear, or should your machine ever need maintenance, Nautilus invites you to call our Virginia Headquarters office for information on parts and service.

Nautilus has available: detailed isometric drawings on the website @ www.nautilus.com for each machine manufactured, genuine Nautilus Upholstery Pads, Naugahyde[®] Spray Cleaner/Conditioner recommended for Nautilus upholstery pads and TFL #50 Wet Lubricant recommended for the care of the guide rods of Nautilus selectorized resistance machines.

Nautilus' concern for the customer does not end with the purchase of equipment. Your comments are always welcomed. In the unlikely event that a problem occurs, call us toll free:



**Nautilus
Customer
Service**

**1-800-235-2233
Fax: 276-773-2298**

Safety

1. Supervision is necessary when the machine is used by or near children, invalids, or disabled persons.
2. Follow the instructions for specific exercises on each machine
3. Get in and out of the equipment carefully.
4. Never operate the machine without shields in place.
5. Use only Nautilus selector pins in weight stack. Never drop or insert any other object into machine opening.
6. Use this machine only as intended or described in this manual.
7. Do not operate equipment with loose or damaged parts. If machine fails to operate correctly, do not attempt to repair. Notify authorized personnel of the problems.
8. Keep hands and feet clear of weights and other moving parts when in use. Keep hands and feet only on the hand grips and foot pads provided.
9. Failure to comply with these instructions may result in personal injury.

CAUTION

Stop exercising immediately if you experience a sharp nerve or joint pain, and seek medical advice.

Before Exercising

To guard against injury, all equipment users should follow these instructions.

- Check with your physician and get approval before beginning a training routine.
- Become familiar with the equipment before beginning a training routine.
- Always warm-up before and cool down after exercising.
- Move slowly during each exercise. Do not jerk or "throw" the weight.
- Breathe freely. Do not hold your breath while lifting or lowering weight.
- Hold movement arms and handles firmly, do not squeeze or grip tightly.
- Structure each workout to exercise the largest muscles first. Suggested routines are found in the Nautilus Total Fitness Program.
- Experiment to find the exact weight you need for each exercise. Select a resistance that allows you to perform eight to twelve slow repetitions. Take two seconds to lift the weight. Pause briefly, and take four seconds to lower the weight.

Maintenance Schedule

	DAILY	WEEKLY	MONTHLY	EVERY 6 MONTHS
General Maintenance				
Check Safety & Warning Decals	■			
Spot Check Belt _____				■
Spot Check Nuts and Bolts _____				■
Spot Check All Pegs and Stops _____				■
Examine Rotation Points _____				■
Cleaning				
Clean Upholstery _____	■			
<i>Use Nautilus Disinfectant Cleaner.</i>				
Clean Surface Area _____		■		
Remove Dust _____				■
Lubrication				
Lubricate and Clean Guide Rods Using TFL 50 _____		■		
<i>Do not lubricate hydraulic cylinders.</i>				

General Maintenance

Frequency of maintenance is determined by several factors: temperature, humidity, use, ventilation and filtration, shielding and friction. External maintenance may vary from daily to monthly, internal maintenance from six months in a club environment to a year when used in a multi-user setting.

1. SPOT CHECK LOOSE NUTS AND BOLTS

- Carefully check rotation points.
- Tighten loose parts immediately. Also check for worn parts, seat belts and upholstery pads.

2. UPHOLSTERY PAD TIGHTENING

Most bolts on upholstery pads can be tightened with a 9/16" combination wrench.

3. SHIELD REMOVAL

Some Nautilus® machines are equipped with quick-release shield fasteners. To remove Quick-Release shielding, gently pull shielding away from the frame. Use a proper screwdriver to remove shield, which is attached to the frame with screws.

4. SHIELD INSTALLATION

Snap Quick-Release in place. Tighten screws only snugly. Use correct phillips screwdriver.

Lubrication

MOVING PARTS

- To clean and lubricate guide rods, apply TFL#50 Wet Lubricant to a clean cloth then use to wipe rods.

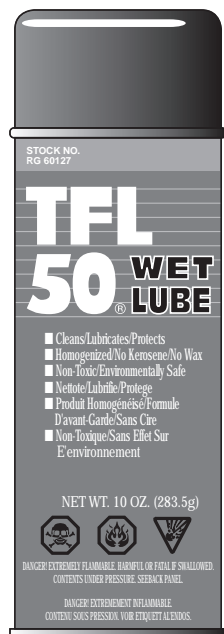

PART NUMBER
19-1160

*TFL 50
Wet
Lubricant

Recommended
for Nautilus
Machines.

Do not place equipment in direct sunlight as ultra violet rays can damage shields and upholstery.

Cleaning

1. UPHOLSTERY CLEANING AND PROTECTION

- Keep pads free of perspiration at all times.
- Clean and disinfect upholstery at the end of each day, especially areas where perspiration and scalp oil collect.
- Clean all outside surfaces with non-abrasive, non-chlorinated household cleaners. Virahol® Disinfectant Cleaner is an effective upholstery care product.

2. CLEANING AND CARE OF PAINTED SURFACES

- Wipe painted surfaces with a damp cloth and car wax.
- Let dry and buff with a dry cloth.

3. CLEANING AND CARE OF ABS PLASTIC SHIELDING

- Clean with non-abrasive, non-chlorinated household cleaners.
- Vacuum or wipe dust from recessed areas and surfaces.

QUIK FILL® 33 Detergent/Disinfectant Odor Counteractant



PART NUMBER
19-1175

An Outstanding liquid quaternary-based product for use in areas where there's heavy soiling. Provides the best odor counteraction available from a disinfectant. Available in ready-to-use; no mixing or dilution 16 oz. spray bottle. USDA Code 1, EPA Reg. 42964-

TO PLACE AN ORDER
Give our friendly Customer Service Representatives a call to order this product or any other Genuine Nautilus Parts

1-800-235-2233

NAUTILUS
709 Powerhouse Road ♦ Independence, VA 24348